

# UNITED STATES PUBLIC LAND SURVEY CORNER CERTIFICATE

LAND SURVEY MONUMENTS SITUATED IN SECTION 16, TOWNSHIP 85 N.,  
RANGE 4 W., OF THE 5th. PRINCIPAL MERIDIAN, JONES  
COUNTY, IOWA.

N NO SCALE

RECOVERY TIE DRAWING

*NE sec. 17*

*NW COR*

*ON COR  
5-16-91*

*ON COR  
5-16-91*

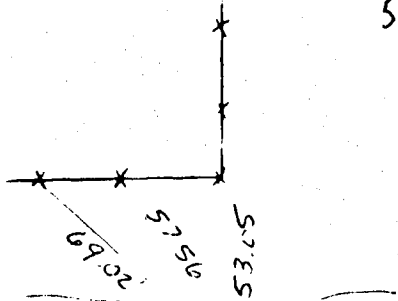
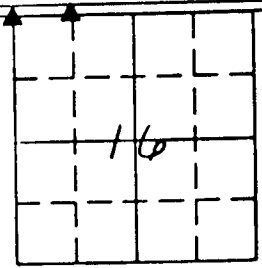

*NE COR NW 1/4 NW 1/4*

▲ ROCK ROAD

ROCK ROAD

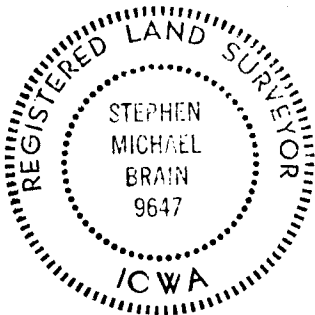
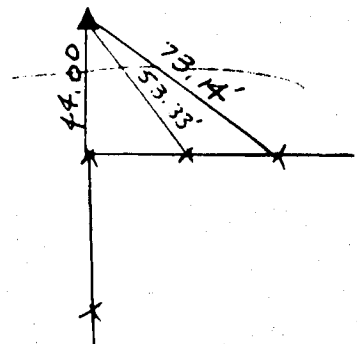

PREVIOUSLY RECORDED IN BOOK \_\_\_ PAGE \_\_\_

PREVIOUSLY RECORDED IN BOOK \_\_\_ PAGE \_\_\_

MONUMENT DESCRIPTION AND HOW ESTABLISHED: \_\_\_\_\_

MONUMENT DESCRIPTION AND HOW ESTABLISHED: \_\_\_\_\_

*FOUND 5/8" BRASS*

*RESET PK NAIL FROM TIES*

I HEREBY DECLARE THAT THE SURVEY WORK WAS COMPLETED AND THIS CERTIFICATE WAS PREPARED BY ME OR UNDER MY DIRECT PERSONAL SUPERVISION AND THAT I AM A DULY REGISTERED LAND SURVEYOR UNDER THE LAWS OF THE STATE OF IOWA.

*Stephen Michael Brain*  
STEPHEN MICHAEL BRAIN, P.E. & L.S. 9647

List Corners to be Indexed

Corners	Section	Twp	Range
NE	17	85	4
SW	9	85	4
SE	8	85	4
NW COR NE 1/4 NW 1/4 16		85	4

**2** AMENT ENGINEERING, INC.  
HIAWATHA, IOWA

*9647 No 25-101 9647 No 25-101*