

COPY

FEE BOOK: 2009 0840 3/9/2009 11:58 AM

REC FEES: No Fee

PAGES: 1

Marie Krutzfield, Recorder  
Jones County, Iowa

PREPARED BY

CLARENCE J. WALTON, JONES COUNTY ENGINEER'S OFFICE, 19501 HWY. 64, ANAMOSA, IOWA, 52205 (319) 462-3785

# UNITED STATES PUBLIC LAND SURVEY CORNER CERTIFICATE

LAND SURVEY MONUMENTS SITUATED IN SECTION 17, TOWNSHIP 86 NORTH,  
RANGE 4 WEST OF THE 5TH PRINCIPAL MERIDIAN, JONES COUNTY, IOWA.

**OFFICE FILE NO.**

STATE PLANE COORDINATE  
NAD 83 IOWA NORTH  
N 3565384.77  
E 5507070.36

CORNER SECTION TOWNSHIP RANGE  
CENTER 17 T86N R4W



NO SCALE

NOTE:  
THE STATE PLANE COORDINATE AS INDICATED IS FOR CONVENIENCE ONLY.  
THE TIES AS SHOWN SHOULD BE USED TO REPLACE THE CORNER, IF  
DESTROYED

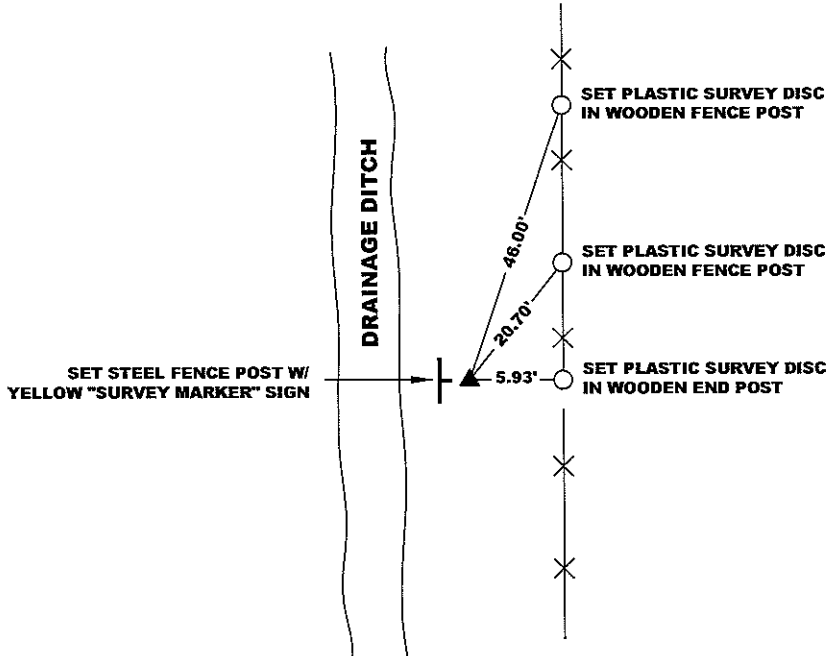

OPC ORANGE PLASTIC CAP  
( ) RECORDED AS

PREVIOUSLY RECORDED IN RECORDER'S DOCUMENT N/A

MONUMENT DESCRIPTION AND HOW ESTABLISHED PROBED EXTENSIVELY BUT FOUND NO LIMESTONE. DUE TO CONSTRUCTION OF DRAINAGE  
IT SEEMS LIKELY THAT THE ORIGINAL STONE WAS DESTROYED AS BORN OUT BY AMOUNT OF GRANITE FIELD STONE SCATTERED ABOUT. SET 5/8" REBAR W/  
ORANGE PLASTIC CAP #11310 FLUSH WITH SURFACE AT INTERSECTION OF LINES FROM THE N 1/4 CORNER SECTION 17-T86N-R4W TO THE S 1/4 OF SAID  
SECTION 17 AND FROM THE W 1/4 CORNER OF SAID SECTION 17 TO THE E 1/4 CORNER OF SAID SECTION 17. SET STEEL FENCE POST W/ YELLOW "SURVEY  
MARKER" SIGN AS A WITNESS TO CORNER.

FIELD BOOK 377, PAGE 149. DATE OF SURVEY: 3/03/09

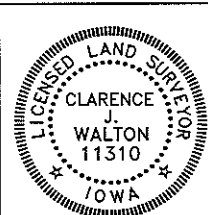

I hereby certify that this land surveying document and the related survey work was performed by me or under my direct personal supervision and that I am a duly registered Land Surveyor under the laws of the State of Iowa.

Signed: *Clarence J. Walton* 3/9/09  
Clarence J. Walton, L.S.  
My Registration Renewal Date is December 31, 2009  
Iowa License Number 11310  
Pages or sheets covered by this seal: 1 of 1.

- A. THERE IS NO CERTIFICATE FOR THE CORNER ON FILE WITH THE RECORDER OF THE COUNTY IN WHICH THE CORNER IS LOCATED.
- B. THE CORNER MONUMENT HAS BEEN REPLACED OR MODIFIED.
- C. THE SURVEYOR IN RESPONSIBLE CHARGE OF THE LAND SURVEYING ACCEPTS A CORNER POSITION THAT DIFFERS FROM THAT SHOWN IN THE PUBLIC RECORDS OF THE COUNTY IN WHICH THE CORNER IS LOCATED.
- D. THE REFERENCE TIES REFERRED TO IN AN EXISTING PUBLIC RECORD NO LONGER EXIST.

**CORNERS TO BE INDEXED**

CORNER	SECTION	TOWNSHIP	RANGE
CENTER	17	86N	4W

**JONES COUNTY ENGINEER'S OFFICE**



19501 HWY. 64, ANAMOSA, IOWA 52205  
(319) 462-3785