

Marie Krutzfield, Recorder
Jones County, Iowa

PREPARED BY

CLARENCE J. WALTON, JONES COUNTY ENGINEER'S OFFICE, 19501 HWY. 64, ANAMOSA, IOWA, 52205 (319) 462-3785

UNITED STATES PUBLIC LAND SURVEY CORNER CERTIFICATE

LAND SURVEY MONUMENTS SITUATED IN SECTION 18, TOWNSHIP 86 NORTH,
RANGE 4 WEST OF THE 5TH PRINCIPAL MERIDIAN, JONES COUNTY, IOWA.

OFFICE FILE NO.

STATE PLANE COORDINATE
NAD 83 IOWA NORTH
N 3565334.36
E 5504403.12

CORNER SECTION TOWNSHIP RANGE
E 1/4 CORNER 18 T86N R4W

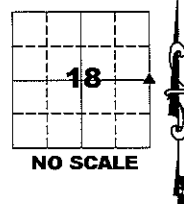

NOTE:
THE STATE PLANE COORDINATE AS INDICATED IS FOR CONVENIENCE ONLY.
THE TIES AS SHOWN SHOULD BE USED TO REPLACE THE CORNER, IF
DESTROYED

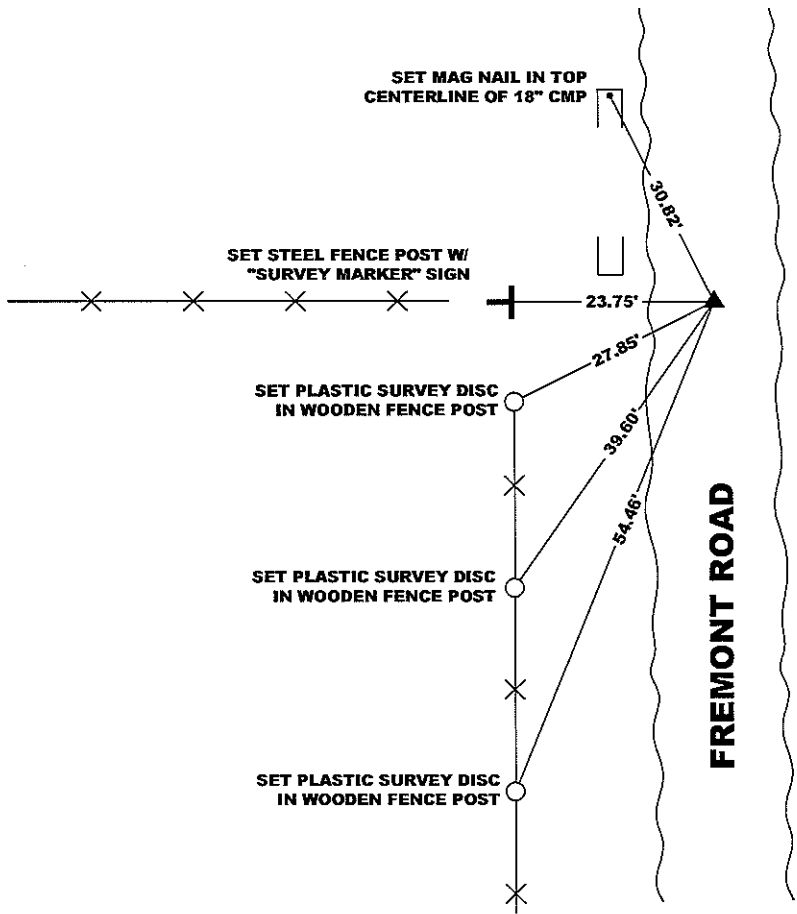

OPC ORANGE PLASTIC CAP
() RECORDED AS

PREVIOUSLY RECORDED IN RECORDER'S DOCUMENT N/A

MONUMENT DESCRIPTION AND HOW ESTABLISHED FOUND 8"X2"X12" LIMESTONE STANDING ON SIDE AND 11"X14"X4" RED GRANITE STONE ON SIDE 24" BELOW PRESENT ROAD SURFACE. BOTH STONE SNUG AGAINST EACH OTHER AND ORIENTED EAST-WEST. SET ONE 5/8" REBAR AGAINST STONES AT EACH CARDINAL COMPASS POINT FOR DETECTION PURPOSES ONLY. SET 5/8" REBAR W/ORANGE PLASTIC CAP 8" BELOW PRESENT ROAD SURFACE. ALSO SET STEEL FENCE POST W/ "SURVEY MARKER" SIGN FOR WITNESS TO CORNER STONES. THERE IS NO PREVIOUS RECORD OF STONES HAVING BEEN SET OR FOUND.

FIELD BOOK 377, PAGE 158. DATE OF SURVEY: 11/25/08

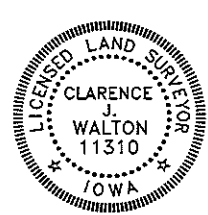

I hereby certify that this land surveying document and the related survey work was performed by me or under my direct personal supervision and that I am a duly registered Land Surveyor under the laws of the State of Iowa.

Signed: *Clarence J. Walton* 12/3/2008
Clarence J. Walton, L.S.
My Registration Renewal Date is December 31, 2009
Iowa License Number 11310
Pages or sheets covered by this seal: 1 of 1.

- A. THERE IS NO CERTIFICATE FOR THE CORNER ON FILE WITH THE RECORDER OF THE COUNTY IN WHICH THE CORNER IS LOCATED.
- B. THE CORNER MONUMENT HAS BEEN REPLACED OR MODIFIED.
- C. THE SURVEYOR IN RESPONSIBLE CHARGE OF THE LAND SURVEYING ACCEPTS A CORNER POSITION THAT DIFFERS FROM THAT SHOWN IN THE PUBLIC RECORDS OF THE COUNTY IN WHICH THE CORNER IS LOCATED.
- D. THE REFERENCE TIES REFERRED TO IN AN EXISTING PUBLIC RECORD NO LONGER EXIST.

CORNERS TO BE INDEXED

CORNER	SECTION	TOWNSHIP	RANGE
E 1/4	18	86N	4W
W 1/4	17	86N	4W

JONES COUNTY ENGINEER'S OFFICE



19501 HWY. 64, ANAMOSA, IOWA 52205
(319) 462-3785