

United States Public Land Survey Corner Certificate

Land survey corner in Section 28 Township 86 North
Range 4 West of the 5th Principal Meridian
Jones County, Iowa.

No Scale

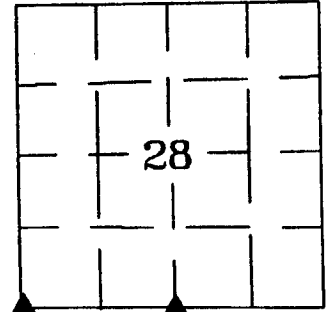
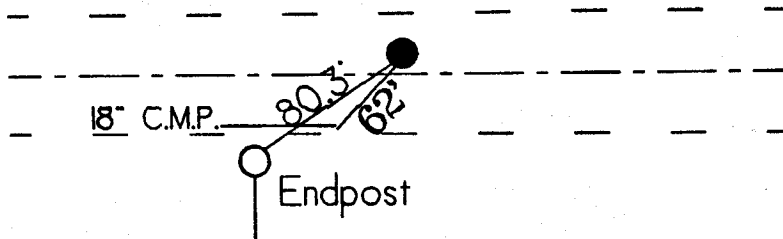

SECTION

SW Cor Sec 28-86-4
Fnd I.P. in paving • Sta 103+36.10
1.95' North of centreline

ON CARD 8-23-93

NE COR SEC. 32 MS.

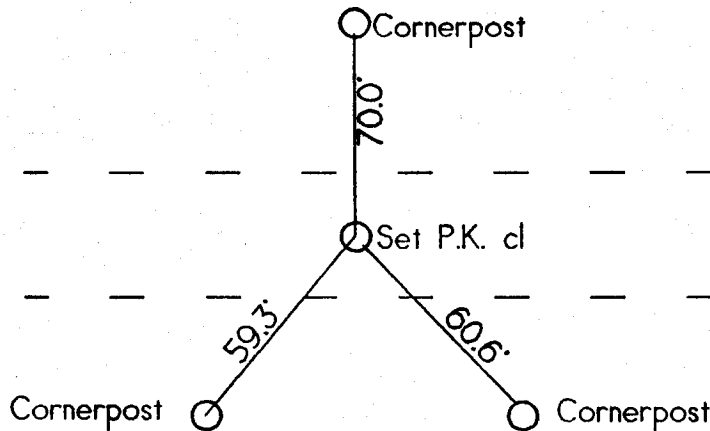

S 1/4 Corner
Section 28-86-4
Set P.K. nail in centreline paving
according to County road plans
• Sta 132+79

Certification

I hereby certify that this plot and survey was made
by me or under my direct supervision and that I am
a duly Registered Land Surveyor under the laws of
the State of Iowa.

Harold E. Dillon
Harold E. Dillon Reg.#6581

7/29/93

date

