

# UNITED STATES PUBLIC LAND SURVEY CORNER CERTIFICATE

OF

Land Survey Monuments situated in Section Four (4), Township 86 North, Range Four (4) West, of the Fifth Principal Meridian, Jones County, Iowa. Previously recorded in \_\_\_\_\_ in County Recorder's Office.

(book, page, document number, etc.)

(Show reason for preparing this certificate, the evidence and detailed procedures used in establishing the corner positions and monumentation found or placed.)

Monument Description and Remarks: Found iron pin using ties from the Jones County Engineers Office.

### PLAN - VIEW

(Show a minimum of three reference ties to durable physical objects, relevant monuments and physical conditions that will enable recovery of the corner.)

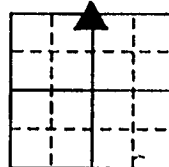

SECTION 4  
T86N, R4W

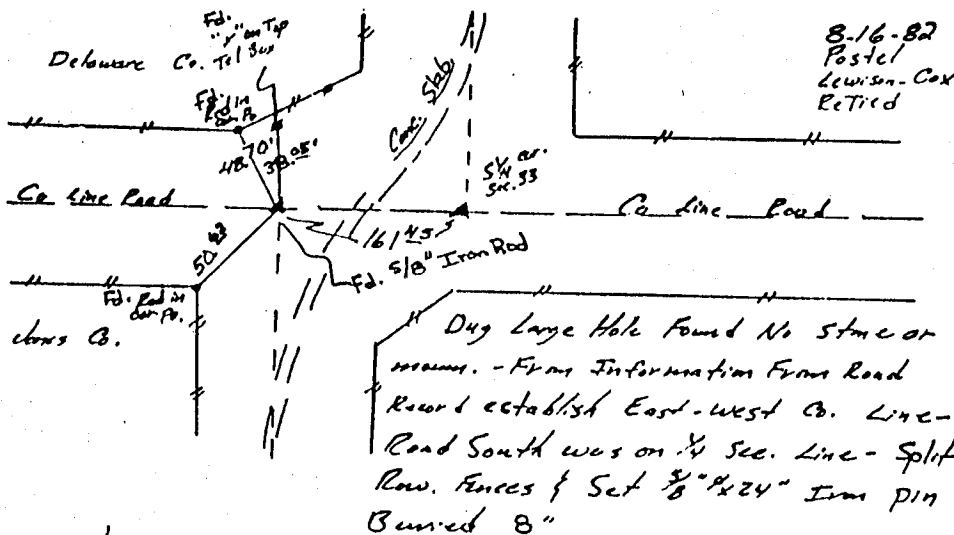

REF. Chas BA\*286

DATE OF FIELD WORK: 11/4/91

TSE NO: 91-64

I hereby certify that the survey work was completed and this certificate was prepared by me or under my direct personal supervision and that I am a duly registered land surveyor under the laws of the state of Iowa.

Signature: J. David Gibbs  
Name typed or printed: J. David Gibbs

Date: 11/25/91 Reg. No. 8419

Corners	List Corners to be Indexed		
	Section	Twp	Range
N 1/4	4	86N	4W

SEAL

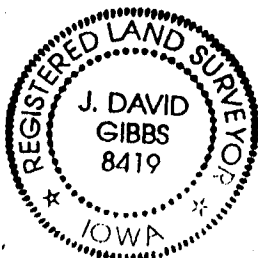

86404C-112791

$N\frac{1}{4}$  Sec. 4

ON  
Cor  
12

~~sec~~

# UNITED STATES PUBLIC LAND SURVEY CORNER CERTIFICATE

OF

Land Survey Monuments situated in Section 33, Township 87 North, Range Four (4) West, of the Fifth Principal Meridian, Delaware County, Iowa. Previously recorded in \_\_\_\_\_ in County Recorder's Office.

(book, page, document number, etc.)  
(Show reason for preparing this certificate, the evidence and detailed procedures used in establishing the corner positions and monumentation found or placed.)

Monument Description and Remarks: Found iron pins using ties from the Jones County Engineers Office.

### PLAN - VIEW

(Show a minimum of three reference ties to durable physical objects, relevant monuments and physical conditions that will enable recovery of the corner.)

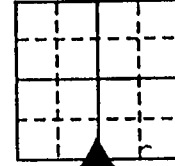

SECTION 33  
T87N, R4W

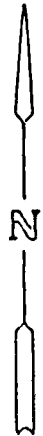
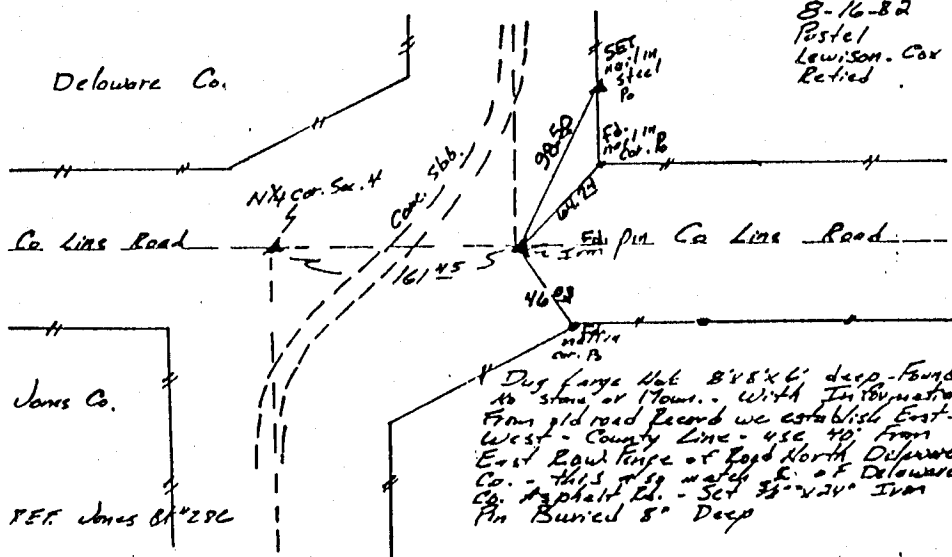

DATE OF FIELD WORK: 11/4/91

TSE NO: 91-64

I hereby certify that the survey work was completed and this certificate was prepared by me or under my direct personal supervision and that I am a duly registered land surveyor under the laws of the state of Iowa.

Signature: J. David Gibbs  
Name typed or printed: J. David Gibbs  
Date: 11/27/91 Reg. No. 8419

Corners	List Corners to be Indexed		
	Section	Twp	Range
S 1/4	33	87N	4W

SEAL

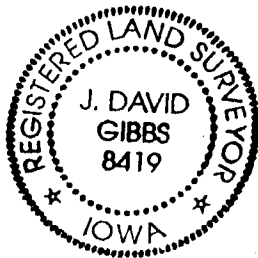

*Delaware Co.*  
*S 1/4 sec. 33*