

SECTION CORNER CERTIFICATE

OF
 LAND SURVEY MONUMENTS SITUATED IN SECTION 3, TOWNSHIP 84 NORTH,
 RANGE 4 WEST, OF THE FIFTH PRINCIPAL MERIDIAN, JONES, COUNTY, IOWA.

PREVIOUSLY RECORDED IN BOOK _____ AT PAGE _____

FOR RECORDER'S USE

REASON FOR PREPARING CERTIFICATE:

- A) THERE IS NO CERTIFICATE FOR THE CORNER ON FILE WITH THE RECORDER OF THE COUNTY IN WHICH THE CORNER IS LOCATED.
- B) CORNER POSITION DIFFERS FROM THAT SHOWN IN THE PUBLIC RECORDS OF THE COUNTY IN WHICH THE CORNER IS LOCATED.
- C) THE CORNER MONUMENT HAS BEEN REPLACED OR MODIFIED.
- D) THE REFERENCE TIES REFERRED TO IN AN EXISTING PUBLIC RECORD ARE INCORRECT.

MONUMENT DESCRIPTION AND REMARKS :

W/4 CORNER SECTION 3-84-4 SET 2" REBAR WITH L.S. CAP # 8165
 FLUSH WITH GROUND 116' ± SOUTH OF SOUTH EDGE OF OLD
 ABANDONED BRIDGE ACROSS BUFFALO CREEK
 E/4 CORNER SECTION 3-84-4 FOUND CONC. MON. WITH BRASS CAP
 2" DEEP 0.5' SOUTH OF COR. POST

RECOVERY TIE DRAWING

W/4 Cor. 3-84-4

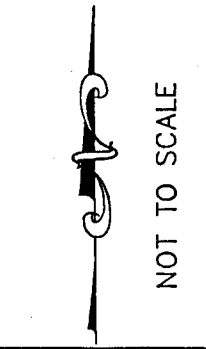
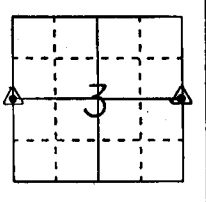
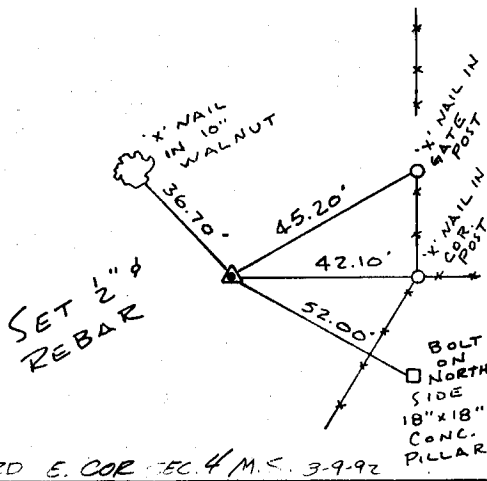

E/4 Cor. 3-84-4

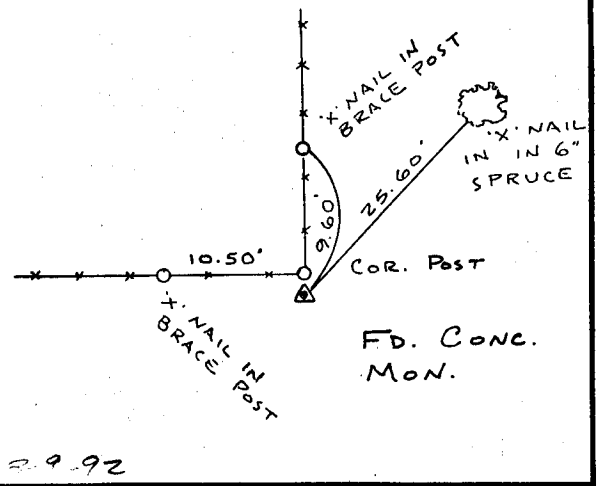

I, GLEN D. MEISNER, CERTIFY THAT THE CORNER LOCATION(S) SHOWN ON THIS RECORD WERE DETERMINED BY ME OR UNDER MY DIRECTION AND CONTROL AND THAT THIS U.S. PUBLIC LAND SURVEY MONUMENT RECORD IS CORRECT AND COMPLETE TO THE BEST OF MY KNOWLEDGE AND BELIEF.



Glen D. Meisner 1-20-92
 GLEN D. MEISNER U.S. NO 8165 DATE

GOVERNMENT CORNER
 5/8" TIE PIN SET
 CENTERLINE
 EXISTING FENCE LINE
 R.O.W. LINE

SHEET TITLE: U.S. PUBLIC LAND SURVEY RECORD
 PROJECT TITLE: GEORGE CASPERS SURVEY

HALL AND HALL ENGINEERS, INC.
 226 29TH STREET DRIVE S.E.
 CEDAR RAPIDS, IOWA 52403
 319-362-9548

DW	R.W.B.	KIC	G.D.M.	APP	DATE	SCALE	FNO	PNO
					1-17-92	NONE	0T22	4466