

2006 2091

FILED
RECORDERS OFFICE
JONES COUNTY IOWA

06 JUN -1 AM 10:10

MARIE KRUTZFIELD
RECORDER

7.00 Pd

- THIS SPACE RESERVED FOR RECORDER'S USE

U.S. PUBLIC LAND SURVEY CORNER CERTIFICATE

FOR LAND SURVEY MONUMENTS SITUATED IN SECTION 7, TOWNSHIP 84 NORTH, RANGE 4 WEST, OF
THE FIFTH PRINCIPAL MERIDIAN, JONES COUNTY, IOWA

REASON FOR PREPARING CERTIFICATE:

- A) THERE IS NO CERTIFICATE FOR THE CORNER ON FILE WITH THE RECORDER.
- B) CORNER FOUND DIFFERS FROM PREVIOUSLY RECORDED CERTIFICATE RECORDED IN BOOK , AT PAGE .

RECOVERY TIE DRAWING

NE COR. NW 1/4 NE 1/4 7-84-4

ALL TIES ARE MMS TIE
DISC WITH NAIL (TYP.)

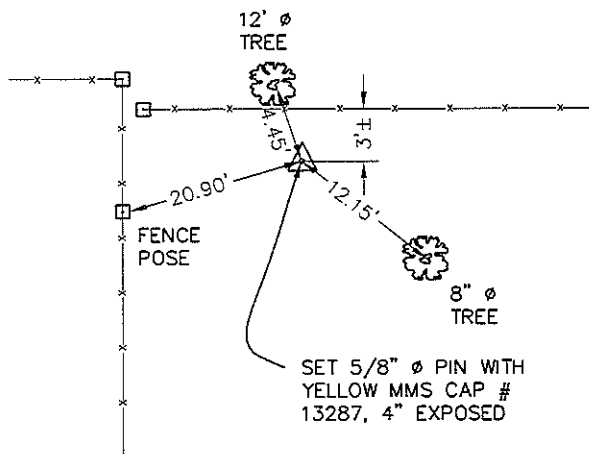

NE CORNER 7 - 84 - 4

ALL TIES ARE MMS TIE
DISC WITH NAIL (TYP.)

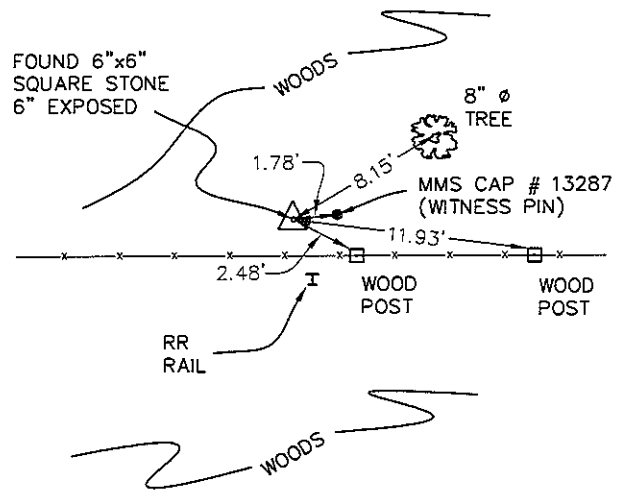

NOT TO SCALE

MONUMENT DESCRIPTION AND REMARKS :

SET 5/8" ϕ PIN WITH YELLOW MMS CAP # 13287, 4" EX-
POSED, AT THE MIDWAY POINT BETWEEN THE NORTHEAST
CORNER AND THE NORTH QUARTER CORNER OF SECTION
7-84-4.

MONUMENT DESCRIPTION AND REMARKS :

FOUND 6" x 6" SQUARE STONE, 6" ABOVE THE GROUND.
THE STONE WAS USED ALONG WITH THE NORTH QUARTER
CORNER OF SECTION 7-84-4, TO ESTABLISH THE NORTH-
EAST CORNER OF THE SOUTHWEST QUARTER OF THE NORTH-
EAST QUARTER OF SECTION 7-84-4, FOUND ON PARCEL
B AS RECORDED IN BOOK 359, PAGE 37 OF THE RECORDS
OF THE JONES COUNTY RECORDER.

I hereby certify that this land surveying document was prepared and
the related survey work was performed by me or under my direct
personal supervision and that I am a duly licensed Land Surveyor
under the laws of the State of Iowa.

James E. Lichty 5/31 20 06
 JAMES E. LICHTY Iowa Lic. No. 13287
 My license renewal date is December 31, 20 06

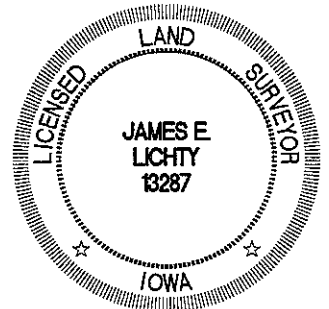

Drawn by: RLS Scale: NONE
 Checked by: JEL Date: 5-31-06
 Field Book: 781 & 792 Project No: IC 7171-004

**U.S. PUBLIC LAND SURVEY
CORNER CERTIFICATE**
 STONE CITY ESTATES, LTD
 JONES COUNTY, IOWA

MMS CONSULTANTS, INC.
 IOWA CITY, IOWA 52240
 (319) 351-8282
 CEDAR RAPIDS, IOWA 52404
 (319) 841-5188
 www.mmsconsultants.net



Date Revision