

2005 0182

FILED  
RECORDERS OFFICE  
JONES COUNTY IOWA

05 JAN 14 PM 1:42

MARIE KRUTZFIELD  
RECORDER *No Fee*

J.D. Tjepkes, LS. JONES COUNTY ENGINEER'S OFFICE, 19501 HWY. 64, ANAMOSA, IOWA, 52205 (319)462-3785

# UNITED STATES PUBLIC LAND SURVEY CORNER CERTIFICATE

LAND SURVEY MONUMENTS SITUATED IN SECTION 24, TOWNSHIP 83  
NORTH, RANGE 4 WEST OF THE 5TH P.M., JONES COUNTY, IOWA

**CORNERS TO BE INDEXED**

CORNER	SECTION	TOWNSHIP	RANGE
NE-SE-SE	24	83N	4W

OFFICE FILE NO. 83424t\_102004.tif

FIELD NOTES:  
8-12-2002  
BK 335  
P 49

1699 ✓

PREVIOUSLY RECORDED IN BOOK NA, PAGE NA  
MONUMENT DESCRIPTION AND HOW ESTABLISHED \_\_\_\_\_  
NOTE: HALL & HALL MARKED LOCATION IN CONJUNCTION WITH  
JONES CO. PROJECT NO. CO-53(38)--55-53. SET 1/2" X 24"  
REBAR W/CAP #11954. RETIED AS INDICATED. NORTHEAST CORNER,  
SOUTHEAST QUARTER, SOUTHEAST QUARTER-24-83-4, JONES COUNTY, IOWA.

**CORNERS TO BE INDEXED**

CORNER	SECTION	TOWNSHIP	RANGE
E-QUARTER	24	83N	4W

OFFICE FILE NO. 83424o\_102004.tif

FIELD NOTES:  
8-12-2002  
BK 335  
P 50

1173 ✓

PREVIOUSLY RECORDED IN BOOK NA, PAGE NA  
MONUMENT DESCRIPTION AND HOW ESTABLISHED \_\_\_\_\_  
NOTE: HALL & HALL MARKED LOCATION IN CONJUNCTION WITH  
JONES CO. PROJECT NO. CO-53(38)--55-53. SET 1/2" X 24"  
REBAR W/CAP #11954. RETIED AS INDICATED. EAST QUARTER  
CORNER SECTION 24 T83N R4W, JONES COUNTY, IOWA.

**CORNERS TO BE INDEXED**

CORNER	SECTION	TOWNSHIP	RANGE
NE-SE-NE	24	83N	4W

OFFICE FILE NO. 83424j\_102004.tif

FIELD NOTES:  
8-26-2002  
BK 335  
P 50

1700 ✓

PREVIOUSLY RECORDED IN BOOK NA, PAGE NA  
MONUMENT DESCRIPTION AND HOW ESTABLISHED \_\_\_\_\_  
NOTE: HALL & HALL MARKED LOCATION IN CONJUNCTION WITH  
JONES CO. PROJECT NO. CO-53(38)--55-53. SET 1/2" X 24"  
REBAR W/CAP #11954. RETIED AS INDICATED. NORTHEAST  
CORNER, SOUTHEAST QUARTER, NORTHEAST QUARTER, SECTION 24  
T83N R4W, JONES COUNTY, IOWA.

**CORNERS TO BE INDEXED**

CORNER	SECTION	TOWNSHIP	RANGE
NORTHEAST	24	83N	4W

OFFICE FILE NO. 83424e\_102004.tif

FIELD NOTES:  
8-26-2002  
BK 335  
P 51

1247 ✓

PREVIOUSLY RECORDED IN BOOK NA, PAGE NA  
MONUMENT DESCRIPTION AND HOW ESTABLISHED \_\_\_\_\_  
NOTE: HALL & HALL MARKED LOCATION IN CONJUNCTION WITH  
JONES CO. PROJECT NO. CO-53(38)--55-53. SET 1/2" X 24"  
REBAR W/CAP #11954. RETIED AS INDICATED. NORTHEAST  
CORNER SECTION 24 T83N R4W, JONES COUNTY, IOWA.

I hereby declare that this plat, survey or report was made by me or under my direct personal supervision and that I am a duly registered Land Surveyor under the laws of the State of Iowa.

Signed: *J.D. Tjepkes* 1-14-05

Joseph D. Tjepkes L.S. Iowa Reg. No. 14807  
My Registration Renewal Date is December 31, 2006

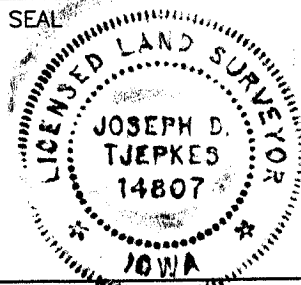

J.D. Tjepkes LS 14807  
JONES COUNTY  
ENGINEER'S OFFICE

19501 HWY. 64,  
ANAMOSA, IOWA,  
52205 (319)462-3785

*E*

2004 0308

FILED  
RECORDERS OFFICE  
JONES COUNTY IOWA

04 JAN 26 PM 12:07

MARIE KRUTZFIELD  
RECORDER 11.00 pd

PREPARED BY

STEPHEN MICHAEL BRAIN, BRAIN ENGINEERING, INC., 1540 MIDLAND COURT NE, CEDAR RAPIDS, IOWA PH. (319) 294-9424

# UNITED STATES PUBLIC LAND SURVEY CORNER CERTIFICATE

LAND SURVEY MONUMENTS SITUATED IN SECTION 13, TOWNSHIP 83 NORTH  
RANGE 4 WEST OF THE 5TH P.M., JONES COUNTY, IOWA.

NO SCALE



NE 24.83.4

SE CORNER

834 24E .012404

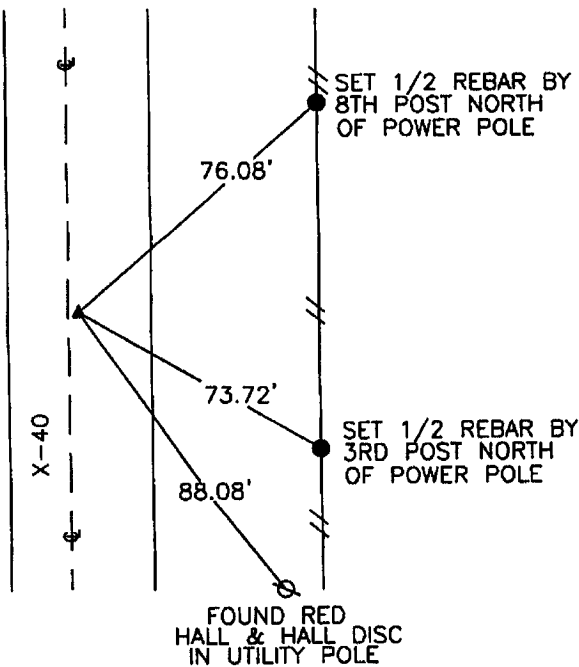
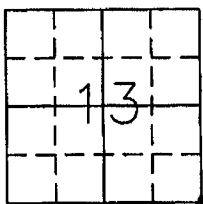

1247

PREVIOUSLY RECORDED IN BOOK \_\_\_\_\_ PAGE \_\_\_\_\_

MONUMENT DESCRIPTION AND HOW ESTABLISHED \_\_\_\_\_

FOUND 1/2" REBAR W/ RED CAP #11954

0.42' EAST OF CENTERLINE OF X-40.

NO SCALE



NE CORNER  
SE 1/4 SE 1/4

834 13E .012404

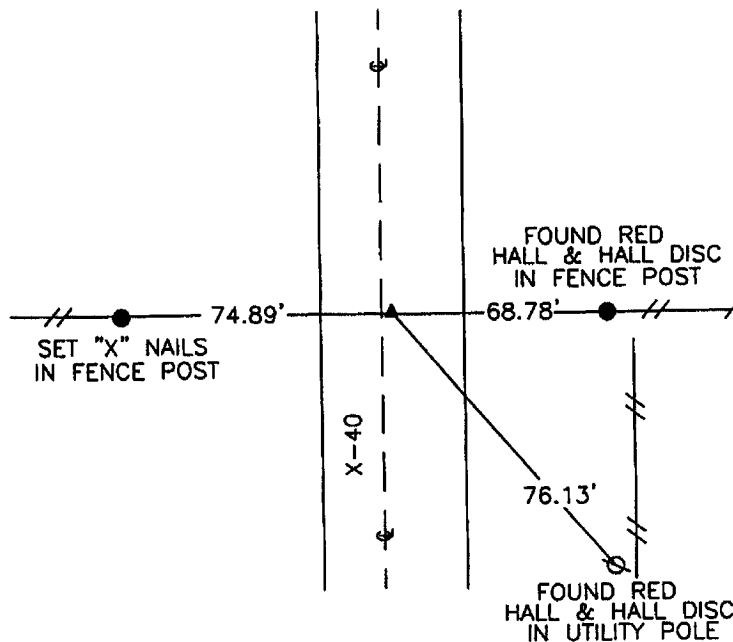
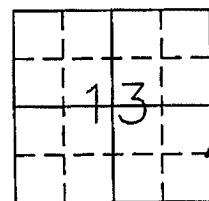

1248

PREVIOUSLY RECORDED IN BOOK \_\_\_\_\_ PAGE \_\_\_\_\_

MONUMENT DESCRIPTION AND HOW ESTABLISHED \_\_\_\_\_

FOUND 1/2" REBAR W/ RED CAP #11954, 0.75 EAST

OF CENTERLINE OF X-40 AND 0.53' EAST OF 1/2" REBAR



I hereby certify that this land surveying document and the related survey work was performed by me or under my direct personal supervision and that I am a duly licensed Land Surveyor under the laws of the State of Iowa.

Signed *[Signature]* Date 1/24/04

Stephen Michael Brain, L.S.  
My License Renewal Date is December 31, 2004  
License Number 9647  
Pages or sheets covered by this seal: 1/1

- A. THERE IS NO CERTIFICATE FOR THE CORNER ON FILE WITH THE RECORDER OF THE COUNTY IN WHICH THE CORNER IS LOCATED
- B. THE SURVEYOR IN RESPONSIBLE CHARGE OF THE LAND SURVEYING ACCEPTS A CORNER POSITION WHICH DIFFERS FROM THAT SHOWN IN THE PUBLIC RECORDS OF THE COUNTY IN WHICH THE CORNER IS LOCATED.
- C. THE CORNER MONUMENT IS REPLACED OR MODIFIED IN ANY WAY.
- D. THE REFERENCE TIES REFERRED TO IN AN EXISTING PUBLIC RECORD ARE NOT CORRECT.

CORNERS TO BE INDEXED			
CORNER	SECTION	TOWNSHIP	RANGE
S 1/4 CORNER	13	T83N	R4W
NF CORNER			

**BRAIN ENGINEERING, INC.**  
1540 MIDLAND COURT NE  
CEDAR RAPIDS, IOWA 52402

31193-

# THIS IS NOT A CERTIFICATION

JONES COUNTY ENGINEER'S OFFICE, 19501 HWY. 64, ANAMOSA, IOWA, 52205 (319)462-3785

## UNITED STATES PUBLIC LAND SURVEY CORNER CERTIFICATE

LAND SURVEY MONUMENTS SITUATED IN SECTION 24, TOWNSHIP 83  
NORTH, RANGE 4 WEST OF THE 5TH P.M., JONES COUNTY, IOWA

**CORNERS TO BE INDEXED**

CORNER SECTION TOWNSHIP RANGE  
NORTHEAST 24 83N 4W

OFFICE FILE NO.

83424e-081203.jpg

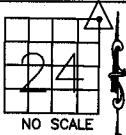

NO SCALE

PRIVATE DR.

1936 INFORMATION:  
COUNTY SURVEY CREW  
KIRCHOFF

37.0'

32.0' 30.5'

NE-24-83-4  
SCM WITH TOP  
16" BELOW  
SURFACE.

ENGINEER'S CORNER STONE

PREVIOUSLY RECORDED IN BOOK #6, PAGE 61  
MONUMENT DESCRIPTION AND HOW ESTABLISHED FOUND BROKEN  
LIMESTONE 3' BELOW SURFACE. LOWERED STONE, SET STANDARD  
CONCRETE MONUMENT DIRECTLY ABOVE WITH TOP 16" BELOW  
SURFACE. TIES AS INDICATED. NORTHEAST CORNER SECTION 24,  
TOWNSHIP 83 NORTH, RANGE 4 WEST OF THE 5TH PRINCIPAL  
MERIDIAN, JONES COUNTY, IOWA.

1247

**CORNERS TO BE INDEXED**

CORNER SECTION TOWNSHIP RANGE

OFFICE FILE NO.

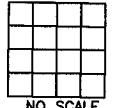

NO SCALE

PREVIOUSLY RECORDED IN BOOK \_\_\_\_\_, PAGE \_\_\_\_\_  
MONUMENT DESCRIPTION AND HOW ESTABLISHED \_\_\_\_\_  
\_\_\_\_\_  
\_\_\_\_\_

**CORNERS TO BE INDEXED**

CORNER SECTION TOWNSHIP RANGE

OFFICE FILE NO.

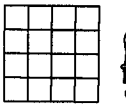

NO SCALE

PREVIOUSLY RECORDED IN BOOK \_\_\_\_\_, PAGE \_\_\_\_\_  
MONUMENT DESCRIPTION AND HOW ESTABLISHED \_\_\_\_\_  
\_\_\_\_\_  
\_\_\_\_\_

**CORNERS TO BE INDEXED**

CORNER SECTION TOWNSHIP RANGE

OFFICE FILE NO.

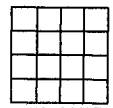

NO SCALE

PREVIOUSLY RECORDED IN BOOK \_\_\_\_\_, PAGE \_\_\_\_\_  
MONUMENT DESCRIPTION AND HOW ESTABLISHED \_\_\_\_\_  
\_\_\_\_\_  
\_\_\_\_\_

~~I hereby declare that this plat, survey or report was made by me or under my direct personal supervision and that I am a duly registered Land Surveyor under the laws of the State of Iowa.~~

Signed:

SEAL

JONES COUNTY  
ENGINEER'S OFFICE

19501 HWY. 64,  
ANAMOSA, IOWA,  
52205 (319)462-3785