

# U.S. PUBLIC LAND SURVEY CORNER CERTIFICATE

OF  
 LAND SURVEY MONUMENTS SITUATED IN SECTION 16, TOWNSHIP 83 NORTH,  
 RANGE 2 WEST, OF THE FIFTH PRINCIPAL MERIDIAN, JONES, COUNTY, IOWA.

PREVIOUSLY RECORDED IN BOOK \_\_\_\_\_ AT PAGE \_\_\_\_\_

FOR RECORDER'S USE

**REASON FOR PREPARING CERTIFICATE:**

- A) THERE IS NO CERTIFICATE FOR THE CORNER ON FILE WITH THE RECORDER OF THE COUNTY IN WHICH THE CORNER IS LOCATED.
- B) CORNER POSITION DIFFERS FROM THAT SHOWN IN THE PUBLIC RECORDS OF THE COUNTY IN WHICH THE CORNER IS LOCATED.
- C) THE CORNER MONUMENT HAS BEEN REPLACED OR MODIFIED.
- D) THE REFERENCE TIES REFERRED TO IN AN EXISTING PUBLIC RECORD ARE INCORRECT.

**MONUMENT DESCRIPTION AND REMARKS :**

SW COR SEC 16 T 83 N R 2 W SET 5/8" REBAR W/ CAP # 8165  
 S 1/4 COR SEC 16 T 83 N R 2 W Fd. 5/8" REBAR

## REFERENCE TIE DRAWING

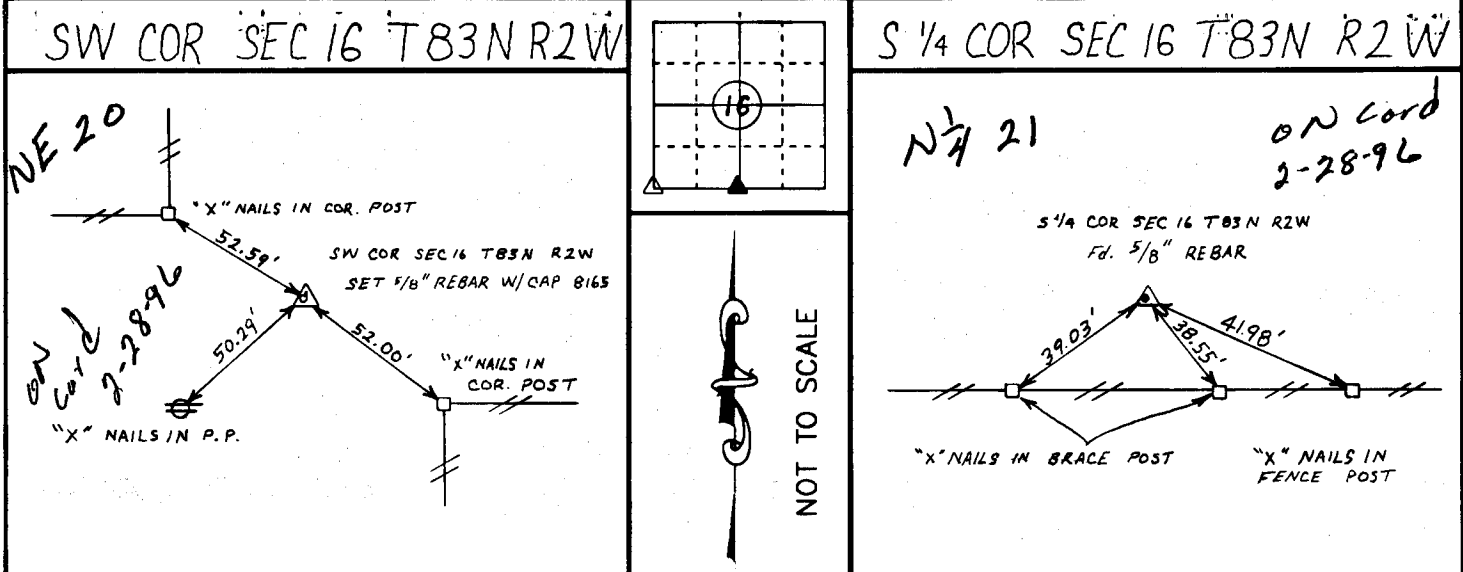

I HEREBY CERTIFY THAT THE CORNER LOCATION(S) SHOWN ON THIS RECORD WERE DETERMINED BY ME OR UNDER MY DIRECT PERSONAL SUPERVISION AND THAT THIS U.S. PUBLIC LAND SURVEY MONUMENT RECORD IS CORRECT AND COMPLETE TO THE BEST OF MY KNOWLEDGE AND BELIEF.

Glen D. Meisner 5-11-95  
 Glen D. Meisner, P.E. & L.S. Ia. Reg. No. 8165  
 My Biennial Registration Expires December 31, 1995.

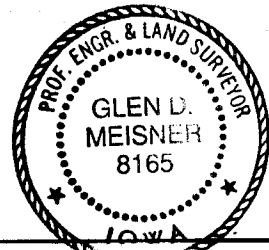

<b>DZ/MG/ML</b>	△ GOVERNMENT CORNER ○ 5/8" TIE PIN SET --- CENTERLINE -x-x- EXISTING FENCE LINE - - - R.O.W. LINE	SHEET TITLE: U.S. PUBLIC LAND SURVEY CORNER CERTIFICATE PROJECT TITLE: <u>BERNET</u>	MMS CONSULTANTS, INC. Iowa City, Iowa 319-351-8282
	D/W B.L.J.    C/K G.D.M.    A/P G.D.M.    DATE 4-19-95    SCALE NONE	F# 402    PROJ# 4292-001	