

Instrument #: 2015-1075
 04/21/2015 12:02:24 PM Total Pages: 1
 ZSC SECTION CORNER CERTIFICATE
 Recording Fee: \$7.00 Transfer Tax: \$0
 Marie Krutzfield, Recorder, Jones County Iowa



PREPARED BY: MICHAEL J. WEBER, WEBER SURVEYING, LLC, 26789 46TH AVE, BERNARD, IA 52032 (563) 879-4173

UNITED STATES PUBLIC LAND SURVEY CORNER CERTIFICATE OF

LAND SURVEY MONUMENTS SITUATED IN SECTION 19, TOWNSHIP 83 NORTH, RANGE 1 WEST
 OF THE FIFTH PRINCIPAL MERIDIAN, JONES COUNTY, IOWA.
 PREVIOUSLY RECORDED BOOK 356 PAGES 106 & 107
(book, page, document number, etc.)

(Show reason for preparing this certificate, the evidence and detailed procedures used in establishing the corner positions and monumentation found or placed.)

Monument Description and Remarks:

-WEST 1/4, SEC. 19, T.83N. R.1W. OF THE 5TH P.M. FOUND 1/2" REBAR W/RED CAP NO. 11954 PER SECTION CORNER CERTIFICATE IN BOOK 356 PAGE 107 OF THE JONES COUNTY RECORDER'S OFFICE. ESTABLISHED NEW TIES.

-SW CORNER, SEC. 19, T.83N. R.1W. OF THE 5TH P.M. FOUND 1/2" REBAR W/RED CAP NO. 11954 PER SECTION CORNER CERTIFICATE IN BOOK 356 PAGE 106 OF THE JONES COUNTY RECORDER'S OFFICE. ESTABLISHED NEW TIES.

(Show a minimum of three reference ties to durable physical objects, relevant monuments and physical conditions that will enable recovery of the corner)

PLAN - VIEW

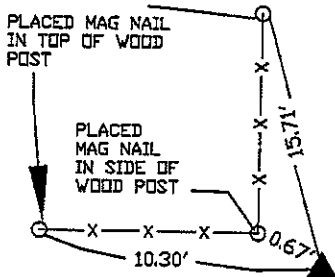

-WEST 1/4, SEC. 19, T.83N. R.1W. OF THE 5TH P.M.
 FOUND 1/2" REBAR W/RED CAP NO. 11954

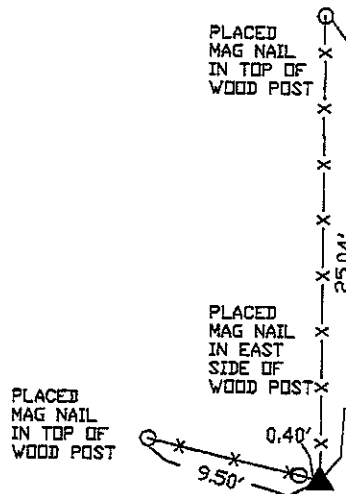

-SW COR., SEC. 19, T.83N. R.1W. OF THE 5TH P.M.
 FOUND 1/2" REBAR W/RED CAP NO. 11954

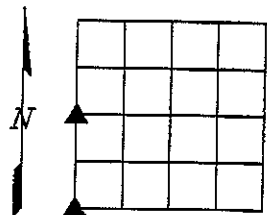

DRAWING NOT TO SCALE

DWG. NO. 14040-AHRENDSEN

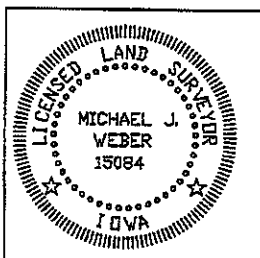

I HEREBY CERTIFY THAT THIS LAND SURVEYING DOCUMENT WAS PREPARED AND THE RELATED SURVEY WORK WAS PERFORMED BY ME OR UNDER MY DIRECT PERSONAL SUPERVISION AND THAT I AM A DULY LICENSED LAND SURVEYOR UNDER THE LAWS OF THE STATE OF IOWA.

Michael J. Weber April 21, 2015
 MICHAEL J. WEBER DATE
 LICENSE NUMBER 15084
 MY LICENSE RENEWAL DATE IS DECEMBER 31, 2015

SHEETS COVERED BY THIS SEAL: _____ THIS SHEET

List Corners to be Indexed		
Corner	Sec	Twp Range
WEST 1/4	19	83N 1W
SW COR.	19	83N 1W

SECTION CORNER CERTIFICATE

OF
 LAND SURVEY MONUMENTS SITUATED IN SECTION 19, TOWNSHIP 83 NORTH,
 RANGE 1 WEST, OF THE FIFTH PRINCIPAL MERIDIAN, JONES COUNTY, IOWA.

PREVIOUSLY RECORDED IN BOOK _____ AT PAGE _____

FOR RECORDER'S USE

REASON FOR PREPARING CERTIFICATE:

- A) THERE IS NO CERTIFICATE FOR THE CORNER ON FILE WITH THE RECORDER OF THE COUNTY IN WHICH THE CORNER IS LOCATED.
- B) CORNER POSITION DIFFERS FROM THAT SHOWN IN THE PUBLIC RECORDS OF THE COUNTY IN WHICH THE CORNER IS LOCATED.
- C) THE CORNER MONUMENT HAS BEEN REPLACED OR MODIFIED.
- D) THE REFERENCE TIES REFERRED TO IN AN EXISTING PUBLIC RECORD ARE INCORRECT.

MONUMENT DESCRIPTION AND REMARKS:

SW. COR. 19-83-1, SET 1/2" REBAR WITH CAP # 11954
S 1/4 COR. 19-83-1, SET 1/2" REBAR WITH CAP # 11954

RECOVERY TIE DRAWING

S.W. COR. 19-83-1

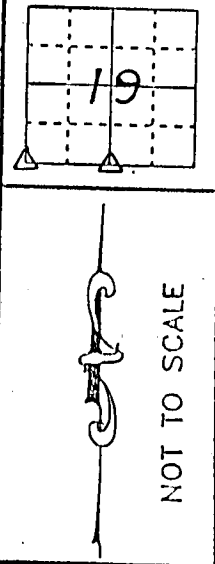
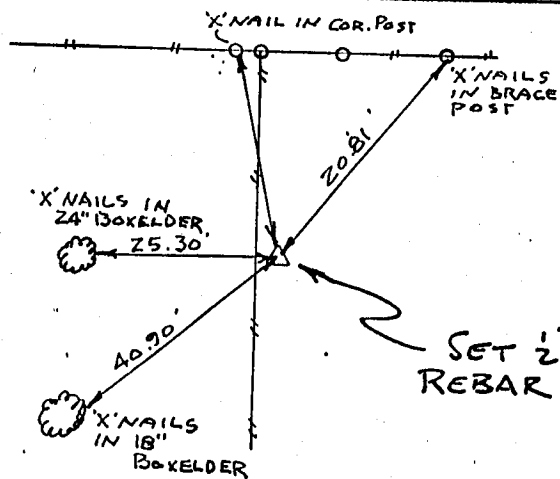

S 1/4 COR. 19-83-1

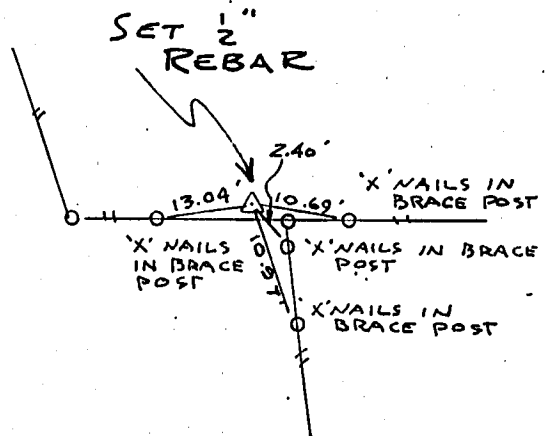

ON CARD NE COR SEC. 25 T8N R2W.
 4-12-94 M.S.

4-12-94
 M.S.

I, DANIEL J. JOHNSON, CERTIFY THAT THE CORNER LOCATION(S) SHOWN ON THIS RECORD WERE DETERMINED BY ME OR UNDER MY DIRECTION AND CONTROL AND THAT THIS U.S. PUBLIC LAND SURVEY MONUMENT RECORD IS CORRECT AND COMPLETE TO THE BEST OF MY KNOWLEDGE AND BELIEF.

Daniel J. Johnson
 DANIEL J. JOHNSON L.S. NO 11954 DATE 3-29-94



L R C O R D	GOVERNMENT CORNER 5/8" TIN PIN SET CENTERLINE EXISTING FENCE LINE R.O.W. LINE	SHEET DATE:	U.S. PUBLIC LAND SURVEY RECORD.	HALL AND HALL ENGINEERS, INC. 226 29TH STREET DRIVE S.E. CEDAR RAPIDS, IOWA 52403 319-362-9548
	PROJECT DATE:	JONES Co. PROJECT FM 53(55)--55-53	SCALE NONE	
D W N D W S	C H K D J J	A P D J J	D A T E 3-2-93	P N O 4716