

97 98 1505

FILED  
RECORDERS OFFICE  
JONES COUNTY IOWA

97 NOV 14 AM 9:54

LINDA J. BENDIXEN  
RECORDER \$ .00 Ad

CLARENCE J. WALTON, L.S., BRAIN ENGINEERING, INC., 777 10TH STREET, MARION, IOWA 52302 (319) 373-1318

# UNITED STATES PUBLIC LAND SURVEY CORNER CERTIFICATE

LAND SURVEY MONUMENTS SITUATED IN SECTION 27, TOWNSHIP 83 NORTH  
RANGE 2 WEST OF THE 5TH P.M., JONES COUNTY, IOWA.

NO SCALE

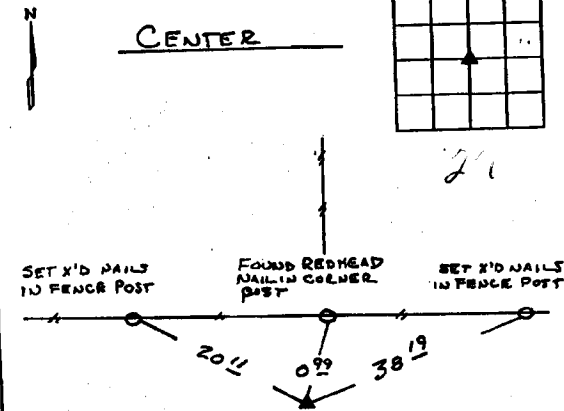

ON  
CORD

NO SCALE

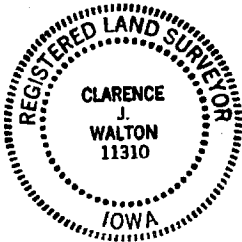
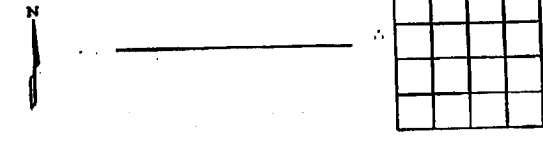

PREVIOUSLY RECORDED IN BOOK \_\_\_\_\_ PAGE \_\_\_\_\_  
MONUMENT DESCRIPTION AND HOW ESTABLISHED \_\_\_\_\_  
FOUND 5/8" ROVAL FROM PREVIOUS SURVEY

PREVIOUSLY RECORDED IN BOOK \_\_\_\_\_ PAGE \_\_\_\_\_  
MONUMENT DESCRIPTION AND HOW ESTABLISHED \_\_\_\_\_

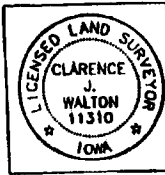

I hereby certify that this land surveying document and the related survey work was performed by me or under my direct personal supervision and that I am a duly Licensed Land Surveyor under the laws of the State of Iowa.

*Clarence J. Walton* Date 11/10/97  
Clarence J. Walton, L.S.  
My License Renewal Date is December 31, 1997  
License Number 11310  
Pages or sheets covered by this set: 1 of 1

CORNERS TO BE INDEXED

| CORNER | SECTION | TOWNSHIP | RANGE |
|--------|---------|----------|-------|
| CENTER | 27      | 83N      | 2W    |

**BRAIN ENGINEERING, INC.**  
777 10TH STREET  
MARION, IOWA 52308  
(319) 373-1318

# 21307.10