

Instrument #: 2022-1434
 05/12/2022 09:01:13 AM Total Pages: 1
 ZSC SECTION CORNER CERTIFICATE
 Recording Fee: \$7.00 Transfer Tax: \$0
 Sheri L. Jones, Recorder, Jones County Iowa



-PREPARED BY AND RETURN TO: MMS CONSULTANTS, INC. 1917 S. GILBERT ST. IOWA CITY, IOWA 52240 (319)351-8282-

U.S. PUBLIC LAND SURVEY CORNER CERTIFICATE

FOR LAND SURVEY MONUMENTS SITUATED IN SECTION 3, TOWNSHIP 84 NORTH, RANGE 3 WEST, OF
 THE FIFTH PRINCIPAL MERIDIAN, JONES COUNTY, IOWA

REASON FOR PREPARING CERTIFICATE:

- A) THERE IS NO CERTIFICATE FOR THE CORNER ON FILE WITH THE RECORDER OF THE COUNTY IN WHICH THE CORNER IS LOCATED.
- B) THE CORNER POSITION DIFFERS FROM THAT SHOWN IN THE PUBLIC RECORDS.
- C) THE CORNER MONUMENT WAS REPLACED OR MODIFIED.
- D) THE REFERENCE TIES REFERRED TO IN AN EXISTING PUBLIC RECORD WERE MISSING OR ARE NOT CORRECT.

RECOVERY TIE DRAWING

CENTER

CENTER
 SEC. 3-T84N-R3W
 SET A 5/8"Ø REBAR
 WITH YELLOW PLASTIC
 CAP 17916 4"±
 EXPOSED

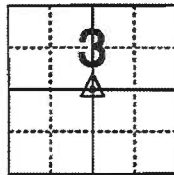
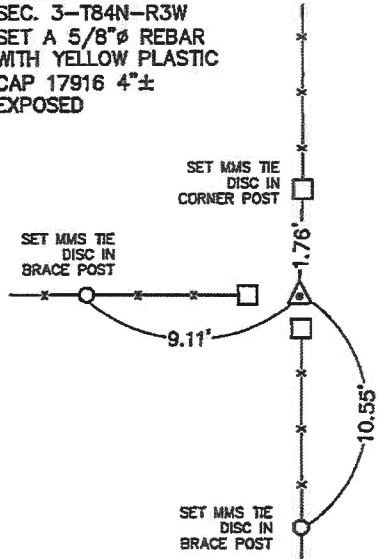

NOT TO SCALE

MONUMENT DESCRIPTION AND REMARKS :

THE CENTER OF SECTION 3, TOWNSHIP 84 NORTH, RANGE 3 WEST OF THE 5TH P.M., USING A MAGNETIC DETECTOR, SEARCHED AND PROBED FOR A METAL MONUMENT AND A STONE HERE TO NO AVAIL. FINDING NOTHING A 5/8"Ø REBAR WITH A YELLOW PLASTIC CAP NO. 17916, WAS SET EXPOSED 4"± NEAR THE THREE WAY INTERSECTION OF A FENCE LINE TO THE NORTH, SOUTH AND WEST. THE MONUMENT WAS TIED OUT AS SHOWN ABOVE. THERE WAS NO PREVIOUS CORNER CERTIFICATE RECORDED FOR THIS SECTION CORNER. THE LOCATION OF THE THEORETICAL (INTERSECTION OF OPPOSITE ONE-QUARTER CORNERS) WAS COMPUTED AND ALSO CONSIDERED BUT IN AN EFFORT TO NOT UNSETTLE THE SETTLED, THE FENCE LINES OF LONG STANDING WERE UTILIZED AS EVIDENCE AND DEEMED A BETTER SOLUTION WHEN LOCATING AND SETTING THE CENTER OF SECTION 3. THIS POSITION AGREES WELL WITH A 40 ACRE FENCE LINE ONE-QUARTER MILE WEST OF THE CENTER POSITION AND A HALF MILE TO THE WEST AT THE W 1/4 CORNER.

MONUMENT DESCRIPTION AND REMARKS :

I hereby certify that this land surveying document was prepared and the related survey work was performed by me or under my direct personal supervision and that I am a duly licensed Professional Land Surveyor under the laws of the State of Iowa.

Richard R. Nowotny 5-9-2022
 RICHARD R. NOWOTNY
 P.L.S. Iowa Lic. No. 17916

My license renewal date is December 31, 2023.

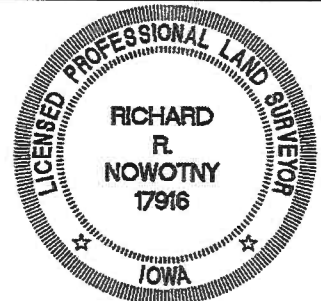

Drawn by:	Scale:
DMW	NONE
Checked by:	Date:
RRN	04/28/2022
Field Book:	Project No:
1339	11208-002

U.S. PUBLIC LAND SURVEY CORNER CERTIFICATE

SECTION 3-T86N-R3W OF THE 5TH P.M.
 JONES COUNTY, IOWA
 EDWARDS PROJECT

MMS CONSULTANTS, INC.
 IOWA CITY, IOWA 52240
 (319) 351-8282
 www.mmsconsultants.net



Date	Revision