

SECTION CORNER CERTIFICATE

Love
Sec. 9

of

LAND SURVEY MONUMENTS SITUATED IN SECTION 9, TOWNSHIP 86 NORTH,
RANGE 3 WEST, OF THE FIFTH PRINCIPAL MERIDIAN, JONES,
COUNTY, IOWA

PREVIOUSLY RECORDED IN BOOK _____ PAGE _____

MONUMENT DESCRIPTION AND REMARKS: Set 1/2"Ø iron rods at both corners.

RECOVERY TIE DRAWING

*Filed on Card
8-17-90
P.P.*

*Filed on Card
8-17-90
P.P.*

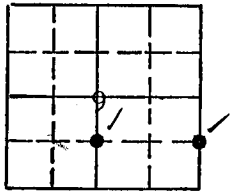

Set 1/2"Ø iron rod w/RLS cap no. 10165
at the SW corner of the NW 1/4-SE 1/4.

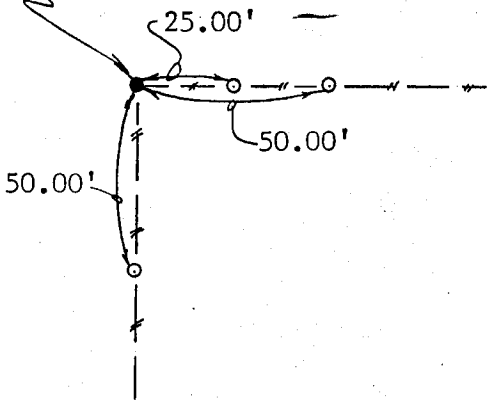

Set 1/2"Ø iron rod at all reference tie points.

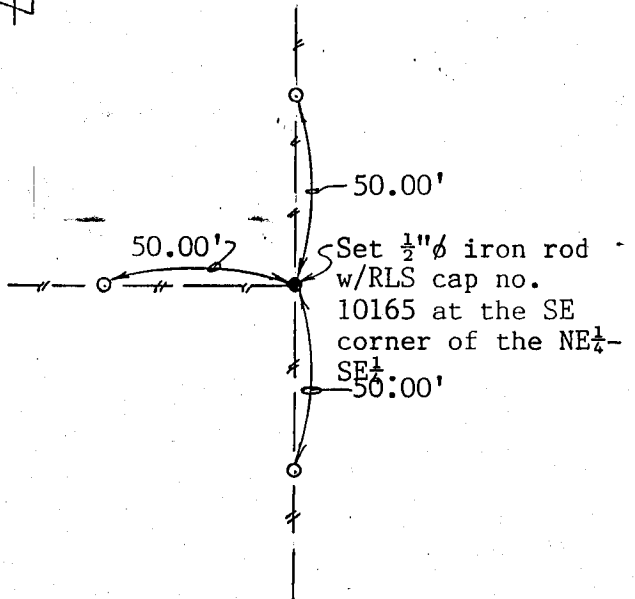

Set 1/2"Ø iron rod at all reference tie points.

STATE OF IOWA SS
COUNTY OF Jones

I HEREBY CERTIFY THAT THE SURVEY WORK WAS
COMPLETED AND THIS CERTIFICATE WAS PREPARED
BY ME OR UNDER MY DIRECT PERSONAL SUPERVISION
AND THAT I AM A DULY REGISTERED LAND SURVEYOR
UNDER THE LAWS OF THE STATE OF IOWA.

Roger R. Mohn
REGISTERED LAND SURVEYOR NO. 10165

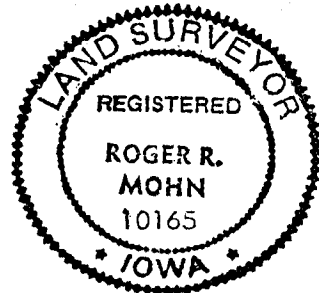

August 13, 1990
DATE

86309r-081390
86309t-081390