

Instrument #: 2016-0863
 04/04/2016 10:19:13 AM Total Pages: 1
 ZSC SECTION CORNER CERTIFICATE
 Recording Fee: \$7.00 Transfer Tax: \$0
 Sheri L. Jones, Recorder, Jones County Iowa



-PREPARED BY AND RETURN TO: MMS CONSULTANTS, INC. 1917 S. GILBERT ST. IOWA CITY, IOWA 52240 (319)351-8282-

U.S. PUBLIC LAND SURVEY CORNER CERTIFICATE
 FOR LAND SURVEY MONUMENTS SITUATED IN SECTION 33, TOWNSHIP 83 NORTH, RANGE 1 WEST, OF
 THE FIFTH PRINCIPAL MERIDIAN, JONES COUNTY, IOWA

REASON FOR PREPARING CERTIFICATE:

- A) THERE IS NO CERTIFICATE FOR THE CORNER ON FILE WITH THE RECORDER OF THE COUNTY IN WHICH THE CORNER IS LOCATED.
- B) CORNER FOUND, OR ITS POSITION, DIFFERS FROM PREVIOUSLY RECORDED CERTIFICATE RECORDED IN BOOK , AT PAGE .
- C) THE CORNER MONUMENT WAS REPLACED OR MODIFIED.
- D) THE REFERENCE TIES REFERRED TO IN AN EXISTING PUBLIC RECORD ARE NOT CORRECT.

RECOVERY TIE DRAWING

NW CORNER SW 1/4 NE 1/4

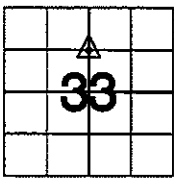
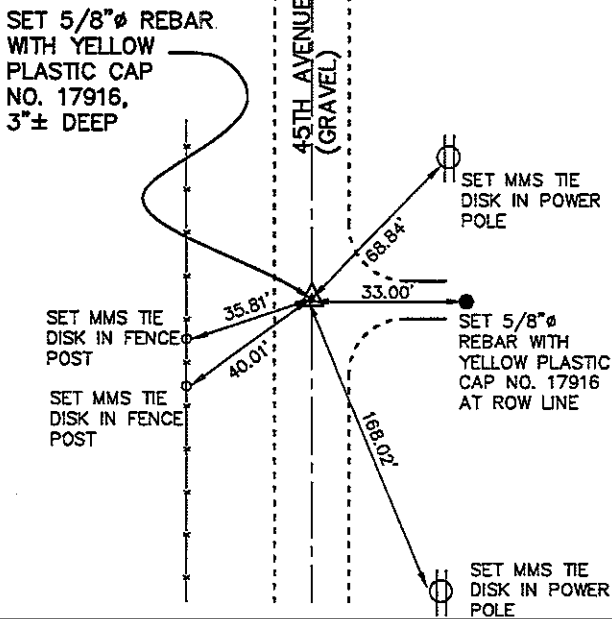

NOT TO SCALE

MONUMENT DESCRIPTION AND REMARKS :

SET 5/8" REBAR WITH YELLOW PLASTIC CAP NO. 17916 AT THE MIDPOINT BETWEEN THE CENTER OF SECTION AND THE N 1/4 CORNER OF SEC. 33-T83N-R1W OF THE 5TH P.M., JONES COUNTY, IOWA. THE REBAR WAS SET 3"± DEEP AND TIED OUT AS SHOWN ABOVE.

MONUMENT DESCRIPTION AND REMARKS :

I hereby certify that this land surveying document was prepared and the related survey work was performed by me or under my direct personal supervision and that I am a duly licensed Professional Land Surveyor under the laws of the State of Iowa.

Richard R. Nowotny 3-30-2016.
 RICHARD R. NOWOTNY, L.S.
 Iowa Lic. No. 17916

My license renewal date is December 31, 20 17

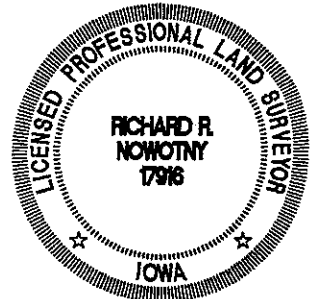

Drawn by: MAS
 Scale: NOT TO SCALE
 Checked by: RRN
 Date: 3/23/2016
 Field Book: 1130
 Project No: IC 9666-012

U.S. PUBLIC LAND SURVEY CORNER CERTIFICATE

SEC. 33-T83N-R1W OF THE 5TH P.M.
 JONES COUNTY, IOWA
 (MIKE NORMAN PROJECT)

MMS CONSULTANTS, INC.
 IOWA CITY, IOWA 52240
 (319) 351-8282
 www.mmsconsultants.net



Date Revision