

SECTION CORNER CERTIFICATE

OF
 LAND SURVEY MONUMENTS SITUATED IN SECTION 19, TOWNSHIP 85 NORTH,
 RANGE 1 WEST, OF THE FIFTH PRINCIPAL MERIDIAN, JONES, COUNTY, IOWA.

PREVIOUSLY RECORDED IN BOOK _____ AT PAGE _____ .

FOR RECORDER'S USE

REASON FOR PREPARING CERTIFICATE:

- A) THERE IS NO CERTIFICATE FOR THE CORNER ON FILE WITH THE RECORDER OF THE COUNTY IN WHICH THE CORNER IS LOCATED.
- B) CORNER POSITION DIFFERS FROM THAT SHOWN IN THE PUBLIC RECORDS OF THE COUNTY IN WHICH THE CORNER IS LOCATED.
- C) THE CORNER MONUMENT HAS BEEN REPLACED OR MODIFIED.
- D) THE REFERENCE TIES REFERRED TO IN AN EXISTING PUBLIC RECORD ARE INCORRECT.

MONUMENT DESCRIPTION AND REMARKS :

W 1/4 CORNER SECTION 19-T85N-R1W SET 1/2" REBAR W/ L.S. CAP # 11954 3" DEEP 11' NORTH OF E OF COUNTY ROAD WEST AND 18.2' WEST OF E OF STATE HWY. No. 136
 S.W. CORNER SECTION 19-T85N-R1W SET P.K. NAIL 10.07' WEST OF E OF STATE HWY. No. 136 ON LINE W/ R.O.W. RAILS

RECOVERY TIE DRAWING

S. W. COR. 19-85-1

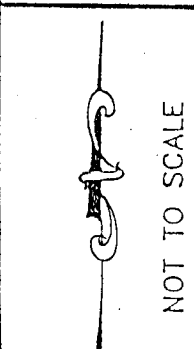
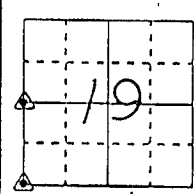
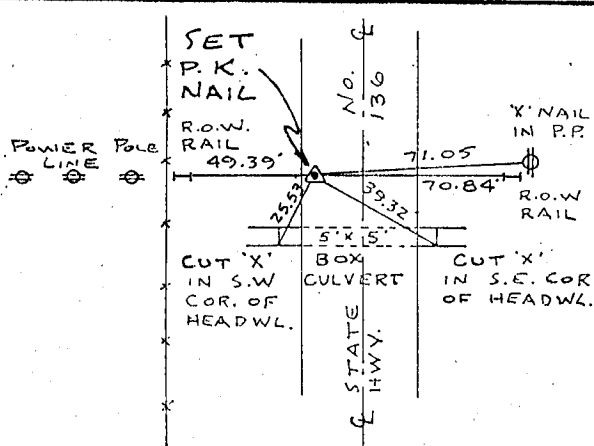

W 1/4 COR. 19-85-1

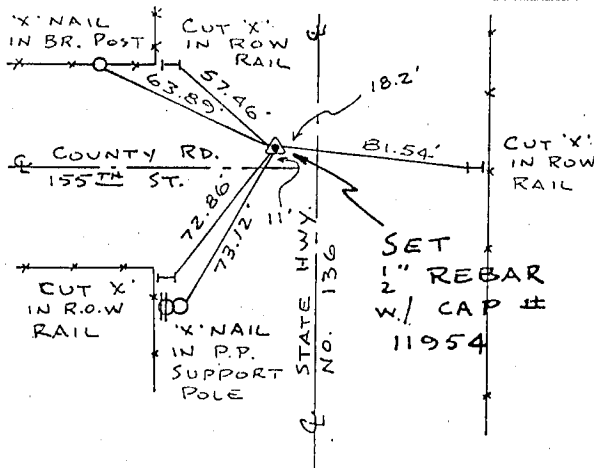

2-25-93 ON CARD E 1/4 COR SEC 24 T85N R1W M.S.

2-25-93 ON CARD NE COR SEC 25 T85N R1W M.S.

I, DANIEL J. JOHNSON, CERTIFY THAT THE CORNER LOCATION(S) SHOWN ON THIS RECORD WERE DETERMINED BY ME OR UNDER MY DIRECTION AND CONTROL AND THAT THIS U.S. PUBLIC LAND SURVEY MONUMENT RECORD IS CORRECT AND COMPLETE TO THE BEST OF MY KNOWLEDGE AND BELIEF.

Daniel J. Johnson 12-30-92
 DANIEL J. JOHNSON L.S. NO 11954 DATE



DEF: A GOVERNMENT CORNER O 5/8" TIC PIN SET --- CENTERLINE - - - EXISTING FENCE LINE - - - R.O.W. LINE	SHEET NO: _____ U.S. PUBLIC LAND SURVEY RECORD	HALL AND HALL ENGINEERS, INC. 226 29TH STREET DRIVE S.E. CEDAR RAPIDS, IOWA 52403 319-362-9548
	PROJECT TITLE: NEAL PAULSEN SURVEY	
DW: R.W.B. CHK: D.J.J. APP: _____	DATE: 5-12-92 SCALE: NONE	P NO: OT25 P NO: 4669