

SECTION CORNER CERTIFICATE

OF
 LAND SURVEY MONUMENTS SITUATED IN SECTION 17, TOWNSHIP 86 NORTH,
 RANGE 1 WEST, OF THE FIFTH PRINCIPAL MERIDIAN, JONES, COUNTY, IOWA.

PREVIOUSLY RECORDED IN BOOK _____ AT PAGE _____

FOR RECORDER'S USE

REASON FOR PREPARING CERTIFICATE:

- A) THERE IS NO CERTIFICATE FOR THE CORNER ON FILE WITH THE RECORDER OF THE COUNTY IN WHICH THE CORNER IS LOCATED.
- B) CORNER POSITION DIFFERS FROM THAT SHOWN IN THE PUBLIC RECORDS OF THE COUNTY IN WHICH THE CORNER IS LOCATED.
- C) THE CORNER MONUMENT HAS BEEN REPLACED OR MODIFIED.
- D) THE REFERENCE TIES REFERRED TO IN AN EXISTING PUBLIC RECORD ARE INCORRECT.

MONUMENT DESCRIPTION AND REMARKS :

S. W. CORNER SECTION 17-T86N-R1W SET 1/2" REBAR W/
 L.S. CAP # 11954 18" DEEP 2' EAST OF NORTH-SOUTH FC.

RECOVERY TIE DRAWING

S. W. COR. 17-86-1

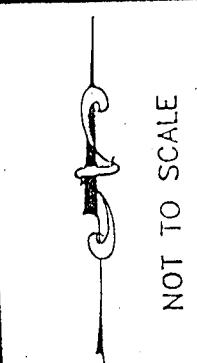
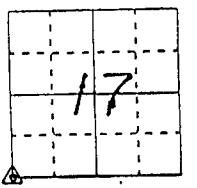
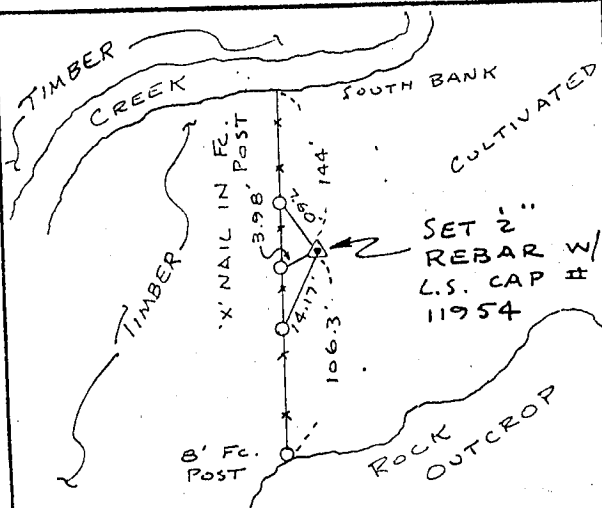

NOT TO SCALE

Z-25-93 ON CARD NE. COR SEC. 19 M.S.

I, DANIEL J. JOHNSON, CERTIFY THAT THE CORNER LOCATION(S) SHOWN ON THIS RECORD WERE DETERMINED BY ME OR UNDER MY DIRECTION AND CONTROL AND THAT THIS U.S. PUBLIC LAND SURVEY MONUMENT RECORD IS CORRECT AND COMPLETE TO THE BEST OF MY KNOWLEDGE AND BELIEF.

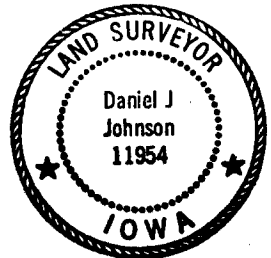

Daniel J. Johnson
 DANIEL J. JOHNSON L.S. NO 11954 DATE 12-30-92

| | | | |
|-------------|--|--|---|
| DEFINITIONS | ▲ GOVERNMENT CORNER ○ 5/8" IRON PIN SET --- CENTERLINE - - - EXISTING FENCE LINE - - - R.O.W. LINE | SHEET TITLE: U.S. PUBLIC LAND SURVEY RECORD PROJECT TITLE: JOSEPH STRANG JR. SURVEY | HALL AND HALL ENGINEERS, INC. 226 29TH STREET DRIVE S.E. CEDAR RAPIDS, IOWA 52403 319-362-9548 |
| | D W N R.W.B C H K D.T.J. A P P | DATE 4-20-92 SCALE NONE | F N O T 2 5 P R O J 4 6 7 1 |