

COPY

Jones County, Iowa  
 Marie Krutzfield, Recorder  
**Fee Book 2010 3414**  
 12/09/2010 @1202PM  
 ZSC SEC COR CERT  
 Book: Page: # Pages: 1  
 Total Fees: \$0.00

PREPARED BY  
**CLARENCE J. WALTON, JONES COUNTY ENGINEER'S OFFICE, 19501 HWY. 64, ANAMOSA, IOWA, 52205 (319) 462-3785**

# UNITED STATES PUBLIC LAND SURVEY CORNER CERTIFICATE

LAND SURVEY MONUMENTS SITUATED IN SECTION 10, TOWNSHIP 85 NORTH,  
 RANGE 3 WEST OF THE 5TH PRINCIPAL MERIDIAN, JONES COUNTY, IOWA.

PROJECT: M-1311

STATE PLANE COORDINATE  
 NAD 83 IOWA NORTH  
 N 3541068.84  
 E 5549917.69

CORNER SECTION TOWNSHIP RANGE  
 NE CORNER 10 T85N R3W  
 SE 1/4 NW 1/4

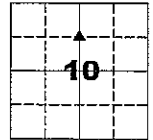

NO SCALE

NOTE:  
 THE STATE PLANE COORDINATE AS INDICATED IS FOR CONVENIENCE ONLY.  
 THE TIES AS SHOWN SHOULD BE USED TO REPLACE THE CORNER, IF  
 DESTROYED

CULTIVATED FIELD

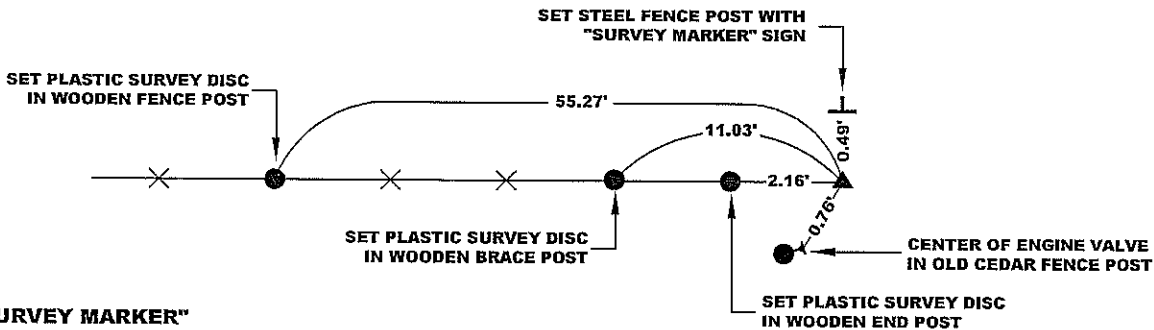

"SURVEY MARKER"  
 SIGN

CULTIVATED FIELD

CULTIVATED FIELD

PLEASE  
 PROTECT  
 NEARBY  
**SURVEY  
 MARKER**

IF LOCATION OF THIS MARK  
 IS ENDANGERED  
 PLEASE CONTACT  
 JONES COUNTY  
 ENGINEER'S OFFICE  
 319-462-3785

SURVEY DISC



OPC ORANGE PLASTIC CAP  
 ( ) RECORDED AS

PREVIOUSLY RECORDED IN RECORDER'S DOCUMENT N/A

MONUMENT DESCRIPTION AND HOW ESTABLISHED DUG AND PROBED AROUND OLD CEDAR POST AND FOUND TRUNCATED TRIANGULAR  
LIMESTONE 12" HEIGHT, 10" BASE, 6" THICK; PLAN VIEW OF TOP IS A TRIANGLE 3" ON A SIDE. STONE IS 14" BELOW PRESENT GROUND. SET THREE  
5/8" X 24" REBAR AROUND STONE TO STABILIZE STONE AND FOR DETECTION PURPOSES. ALSO SET 5/8" X 24" REBAR WITH ORANGE PLASTIC CAP # 11310,  
THE TOP OF WHICH IS DIRECTLY OVER COORDINATES REFERENCE POINT OF STONE. REFERRED TO SURVEY FOR BENEDICT YOUSSE BY HENRY D. SMITH,  
COUNTY SURVEYOR, DECEMBER 11, 1863; RECORDED IN THE RED SURVEYOR'S RECORD BOOK, PAGE 370 IN THE JONES COUNTY, IOWA RECORDER'S  
OFFICE.

FIELD BOOK 437, PAGE 77. DATE OF SURVEY: 10/19/10



I hereby certify that this land surveying document  
 and the related survey work was performed by me  
 or under my direct personal supervision and that  
 I am a duly registered Land Surveyor under the laws  
 of the State of Iowa.  
 Signed: *Clarence J. Walton* 12/9/10  
 Clarence J. Walton, L.S.  
 My Registration Renewal Date is December 31, 2011  
 Iowa License Number 11310  
 Pages or sheets covered by this seal: 1 of 1.

- A. THERE IS NO CERTIFICATE FOR THE CORNER ON FILE WITH THE RECORDER OF THE COUNTY IN WHICH THE CORNER IS LOCATED.
- B. THE CORNER MONUMENT HAS BEEN REPLACED OR MODIFIED.
- C. THE SURVEYOR IN RESPONSIBLE CHARGE OF THE LAND SURVEYING ACCEPTS A CORNER POSITION THAT DIFFERS FROM THAT SHOWN IN THE PUBLIC RECORDS OF THE COUNTY IN WHICH THE CORNER IS LOCATED.
- D. THE REFERENCE TIES REFERRED TO IN AN EXISTING PUBLIC RECORD NO LONGER EXIST.

**CORNERS TO BE INDEXED**

CORNER	SECTION	TOWNSHIP	RANGE
NE CORNER SE 1/4 NW 1/4	10	85N	3W
SE CORNER NE 1/4 NW 1/4	10	85N	3W
SW CORNER NW 1/4 NE 1/4	10	85N	3W
NW CORNER SW 1/4 NE 1/4	10	85N	3W

**JONES COUNTY ENGINEER'S OFFICE**

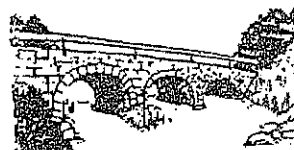

19501 HWY. 64, ANAMOSA, IOWA 52205  
 (319) 462-3785