

COPY

Jones County, Iowa
 Marie Krutzfield, Recorder
 Fee Book 2010 3419
 12/09/2010 @0139PM
 ZSC SEC COR CERT
 Book: Page: # Pages: 1
 Total Fees: \$0.00

PREPARED BY
 CLARENCE J. WALTON, JONES COUNTY ENGINEER'S OFFICE, 19501 HWY. 64, ANAMOSA, IOWA, 52205 (319) 462-3785

UNITED STATES PUBLIC LAND SURVEY CORNER CERTIFICATE

LAND SURVEY MONUMENTS SITUATED IN SECTION 12, TOWNSHIP 85 NORTH,
 RANGE 3 WEST OF THE 5TH PRINCIPAL MERIDIAN, JONES COUNTY, IOWA.

PROJECT: M-1311

STATE PLANE COORDINATE
 NAD 83 IOWA NORTH
 N 3542655.16
 E 5560529.76

CORNER SECTION TOWNSHIP RANGE
 N 1/4 CORNER 12 T85N R3W

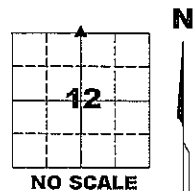

NOTE:
 THE STATE PLANE COORDINATE AS INDICATED IS FOR CONVENIENCE ONLY.
 THE TIES AS SHOWN SHOULD BE USED TO REPLACE THE CORNER, IF
 DESTROYED

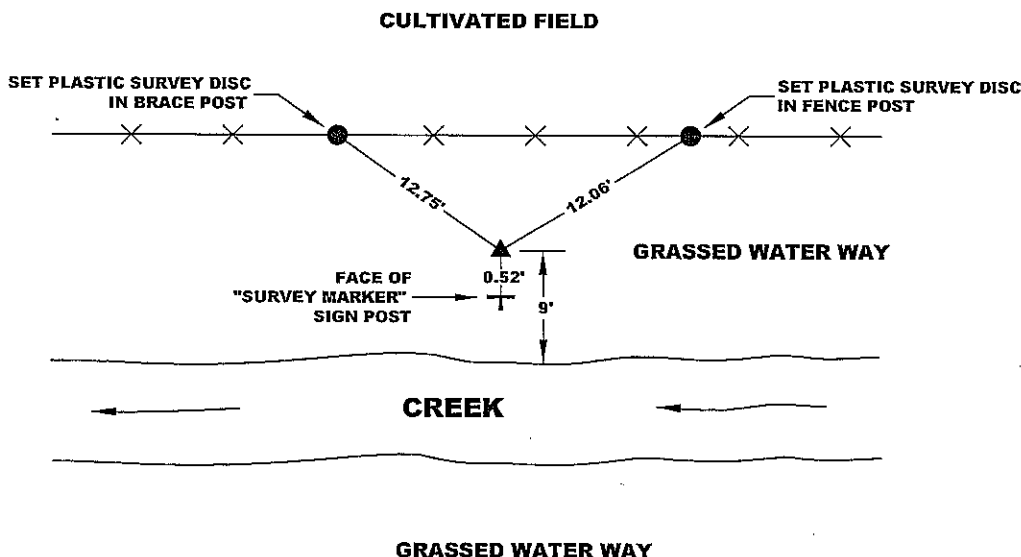

"SURVEY MARKER"
 SIGN

PLEASE
 PROTECT
 NEARBY
**SURVEY
 MARKER**
 IF LOCATION OF THIS MARK
 IS ENDANGERED
 PLEASE CONTACT
 JONES COUNTY
 ENGINEER'S OFFICE
 319-462-3785

SURVEY DISC



OPC ORANGE PLASTIC CAP
 () RECORDED AS

PREVIOUSLY RECORDED IN RECORDER'S DOCUMENT N/A
MONUMENT DESCRIPTION AND HOW ESTABLISHED SET 5/8" X 48" REBAR WITH ORANGE PLASTIC CAP #11310. LEFT TOP OF REBAR 4" ABOVE GROUND SURFACE, AS A TOE STUBBER. A SURVEY DONE FOR HENRY HERRON, JOHN H. HERRON, AND JACOB MATHIESON BY HENRY D. SMITH, COUNTY SURVEYOR, DECEMBER 10, 1863 (RECORDED IN THE RED SURVEYOR'S RECORD, PAGE 372 IN THE JONES COUNTY, IOWA RECORDER'S OFFICE) WAS REFERRED TO AND RETRACED. THE NE CORNER, THE NE CORNER OF THE NW 1/4 NE 1/4, AND THE NW CORNER OF SECTION 12-T85N-R3W WERE FOUND. HENRY SMITH'S SURVEY SHOWS A 25-MINUTE DEFLECTION OF THE NORTH LINE OF SECTION 12 AT THE N 1/4 CORNER OF SECTION 12. A FENCE LINE TO THE NORTH WAS PROJECTED SOUTH AND WAS FOUND TO BE 1.28 FEET WEST OF EQUIDISTANT FROM THE NE CORNER OF SECTION 12 AND THE NW CORNER OF SECTION 12. ALSO, IT WAS FOUND THAT A LINE DRAWN FROM THE NE CORNER OF SECTION 12 THROUGH THE NE CORNER OF THE NW 1/4 NE 1/4 OF SECTION 12 TO A POINT EQUIDISTANT BETWEEN THE NW CORNER OF SECTION 12 AND THE NE CORNER OF SECTION 12 WOULD RESULT IN A DEFLECTION OF 30'37" WITH A LINE FROM THE NW CORNER OF SECTION 12 TO THIS SAID POINT WHICH CLOSELY AGREES WITH SMITH'S SURVEY. IN THIS LIGHT, THE N 1/4 CORNER WAS SET EQUIDISTANT FROM THE NE AND NW CORNERS OF SECTION 12 WITH THE NORTH LINE BEING AN EXTENSION OF THE LINE FROM THE NE CORNER OF SECTION 12 THROUGH THE NE CORNER OF THE NW 1/4 NE 1/4 OF SECTION 12.

FIELD BOOK 437, PAGE 75. DATE OF SURVEY: 10/25/10

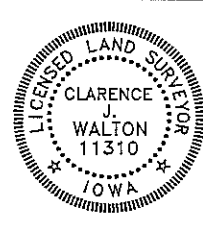

I hereby certify that this land surveying document and the related survey work was performed by me or under my direct personal supervision and that I am a duly registered Land Surveyor under the laws of the State of Iowa.
 Signed: *Clarence J. Walton* 12/9/10
 Clarence J. Walton, L.S.
 My Registration Renewal Date is December 31, 2011
 Iowa License Number 11310
 Pages or sheets covered by this seal: 1 of 1.

- A. THERE IS NO CERTIFICATE FOR THE CORNER ON FILE WITH THE RECORDER OF THE COUNTY IN WHICH THE CORNER IS LOCATED.
- B. THE CORNER MONUMENT HAS BEEN REPLACED OR MODIFIED.
- C. THE SURVEYOR IN RESPONSIBLE CHARGE OF THE LAND SURVEYING ACCEPTS A CORNER POSITION THAT DIFFERS FROM THAT SHOWN IN THE PUBLIC RECORDS OF THE COUNTY IN WHICH THE CORNER IS LOCATED.
- D. THE REFERENCE TIES REFERRED TO IN AN EXISTING PUBLIC RECORD NO LONGER EXIST.

CORNERS TO BE INDEXED			
CORNER	SECTION	TOWNSHIP	RANGE
N 1/4 CORNER	12	85N	3W
S 1/4 CORNER	1	85N	3W

JONES COUNTY ENGINEER'S OFFICE

19501 HWY. 64, ANAMOSA, IOWA 52205
 (319) 462-3785