

COPY

Jones County, Iowa
 Marie Krutzfield, Recorder
Fee Book 2010 3420
 12/09/2010 @0140PM
 ZSC SEC COR CERT
 Book: Page: # Pages: 1
 Total Fees: \$0.00

PREPARED BY
 CLARENCE J. WALTON, JONES COUNTY ENGINEER'S OFFICE, 19501 HWY. 64, ANAMOSA, IOWA, 52205 (319) 462-3785

**UNITED STATES PUBLIC LAND
 SURVEY CORNER CERTIFICATE**

**LAND SURVEY MONUMENTS SITUATED IN SECTION 12, TOWNSHIP 85 NORTH,
 RANGE 3 WEST OF THE 5TH PRINCIPAL MERIDIAN, JONES COUNTY, IOWA.**

PROJECT: M-1311

STATE PLANE COORDINATE
 NAD 83 IOWA NORTH
 N 3542664.76
 E 5561856.24

CORNER SECTION TOWNSHIP RANGE
 NE CORNER 12 T85N R3W
 NW 1/4 NE 1/4

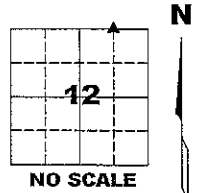

NOTE:
 THE STATE PLANE COORDINATE AS INDICATED IS FOR CONVENIENCE ONLY.
 THE TIES AS SHOWN SHOULD BE USED TO REPLACE THE CORNER, IF
 DESTROYED

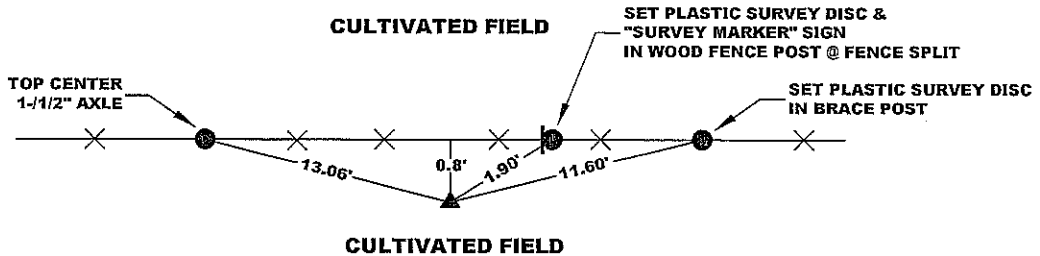

**"SURVEY MARKER"
 SIGN**



SURVEY DISC



OPC ORANGE PLASTIC CAP
 () RECORDED AS

PREVIOUSLY RECORDED IN RECORDER'S DOCUMENT N/A

MONUMENT DESCRIPTION AND HOW ESTABLISHED FOUND 16" X 16" X ± 10" RED GRANITE STONE FLUSH WITH GROUND FOLLOWING SURVEY FOR HENRY HERRON BY HENRY D. SMITH, COUNTY SURVEYOR, DECEMBER 10, 1863; RECORDED IN THE RED SURVEYOR'S RECORD BOOK IN THE JONES COUNTY RECORDER'S OFFICE ON PAGE 372. STONE IS 0.8' SOUTH OF EAST-WEST FENCE LINE. DRILLED HOLE AND SET MAG NAIL WITH ORANGE PLASTIC DISC #11310 AT COORDINATES POINT. SET JONES COUNTY "SURVEY MARKER" SIGN ON WEST SIDE OF WOOD FENCE POST AS A WITNESS TO STONE. SEE TIES FOR N 1/4 CORNER SECTION 12-T85N-R3W FOR FURTHER INFORMATION ON THIS CORNER.

FIELD BOOK 437, PAGE 76. DATE OF SURVEY: 10/25/10

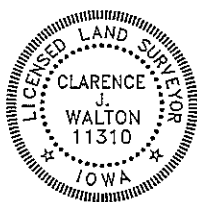

I hereby certify that this land surveying document and the related survey work was performed by me or under my direct personal supervision and that I am a duly registered Land Surveyor under the laws of the State of Iowa.

Signed: *Clarence J. Walton* 12/9/10
 Clarence J. Walton, L.S.
 My Registration Renewal Date is December 31, 2011
 Iowa License Number 11310
 Pages or sheets covered by this seal: 1 of 1.

- A. THERE IS NO CERTIFICATE FOR THE CORNER ON FILE WITH THE RECORDER OF THE COUNTY IN WHICH THE CORNER IS LOCATED.
- B. THE CORNER MONUMENT HAS BEEN REPLACED OR MODIFIED.
- C. THE SURVEYOR IN RESPONSIBLE CHARGE OF THE LAND SURVEYING ACCEPTS A CORNER POSITION THAT DIFFERS FROM THAT SHOWN IN THE PUBLIC RECORDS OF THE COUNTY IN WHICH THE CORNER IS LOCATED.
- D. THE REFERENCE TIES REFERRED TO IN AN EXISTING PUBLIC RECORD NO LONGER EXIST.

CORNERS TO BE INDEXED

CORNER	SECTION	TOWNSHIP	RANGE
NE CORNER NW 1/4 NE 1/4	12	85N	3W
SE CORNER SW 1/4 SE 1/4	1	85N	3W
SW CORNER SE 1/4 SE 1/4	1	85N	3W
NW CORNER NE 1/4 NE 1/4	12	85N	3W

JONES COUNTY ENGINEER'S OFFICE



19501 HWY. 64, ANAMOSA, IOWA 52205
 (319) 462-3785