

UNITED STATES PUBLIC LAND SURVEY CORNER CERTIFICATE

LAND SURVEY MONUMENTS SITUATED IN SECTION 25, TOWNSHIP 85 NORTH
RANGE 3 WEST OF THE 5TH P.M., JONES COUNTY, IOWA.

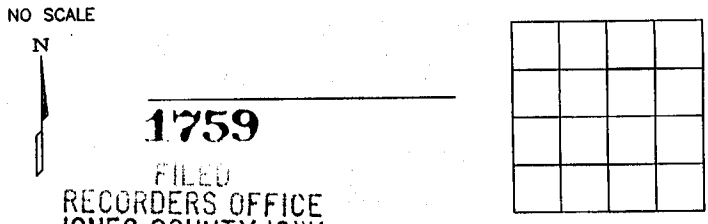
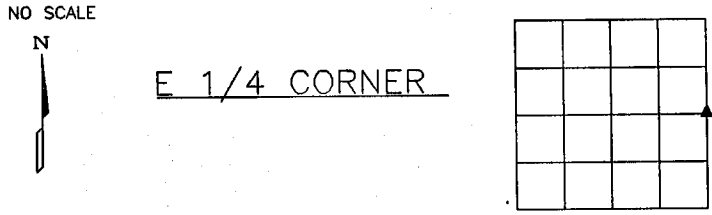

FILED
RECORDERS OFFICE
JONES COUNTY IOWA

92 DEC 30 AM 11: 24

BOOK 331 PAGE 106
DORIS JEANNE HERREN
RECORDER *500 pd*

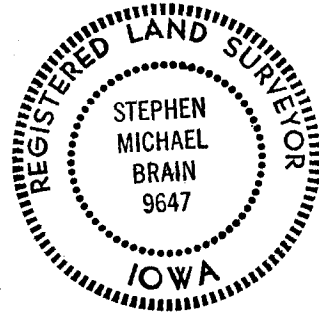
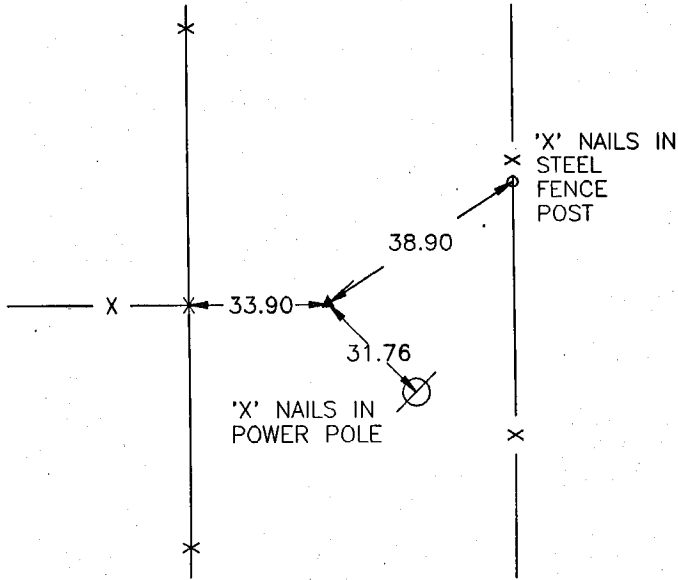

*3-2-93
ON CARD M.S.*

PREVIOUSLY RECORDED IN BOOK _____ PAGE _____
MONUMENT DESCRIPTION AND HOW ESTABLISHED _____
FOUND NAIL AND REPLACED WITH BRIDGE SPIKE _____

PREVIOUSLY RECORDED IN BOOK _____ PAGE _____
MONUMENT DESCRIPTION AND HOW ESTABLISHED _____

I hereby declare that this plat, survey or report was made by me or under my direct personal supervision and that I am a duly registered Land Surveyor under the laws of the State of Iowa.

Signed *Stephen Michael Brain* Date 12/22/92
Stephen Michael Brain, P.E. & L.S. Iowa Reg No. 9647

CORNER	SECTION	TOWNSHIP	RANGE
E 1/4	25	85	3W

BRAIN ENGINEERING, INC.

3132 NORMAN DRIVE
MARION, IOWA 52302
(319) 385-7911

853250-122292