

THIS IS NOT A CERTIFICATION

JONES COUNTY ENGINEER'S OFFICE, 19501 HWY. 64, ANAMOSA, IOWA, 52205 (319)462-3785

UNITED STATES PUBLIC LAND SURVEY CORNER CERTIFICATE

LAND SURVEY MONUMENTS SITUATED IN SECTION 21, TOWNSHIP 84
NORTH, RANGE 1 WEST OF THE 5TH P.M., JONES COUNTY, IOWA

CORNERS TO BE INDEXED

CORNER SECTION TOWNSHIP RANGE
E-QUARTER 21 84N 1W

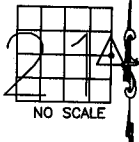

OFFICE FILE NO.
84121o_011304.jpg

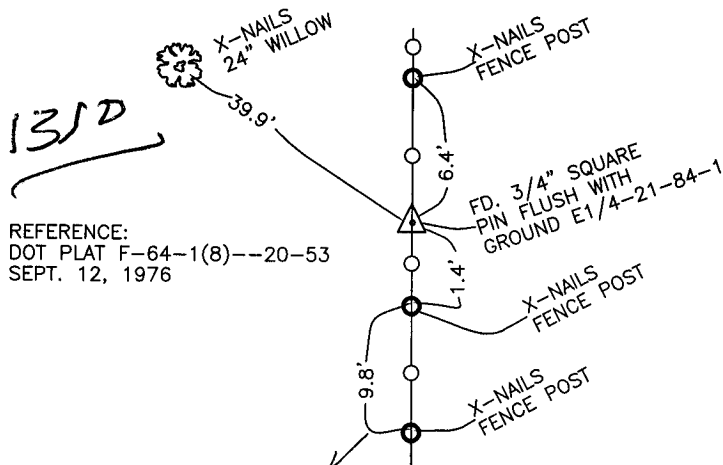

REFERENCE:
DOT PLAT F-64-1(8)--20-53
SEPT. 12, 1976

PREVIOUSLY RECORDED IN BOOK _____, PAGE _____
MONUMENT DESCRIPTION AND HOW ESTABLISHED INFORMATION
FOR THE ABOVE TAKEN FROM DOT PLAT F-64-1(8)--20-53, FOUND
3/4"x10" SQUARE IRON PIN FLUSH WITH GROUND. EAST QUARTER
CORNER SECTION 20, TOWNSHIP 84 NORTH, RANGE 1 WEST OF THE
5TH PRINCIPAL MERIDIAN, JONES COUNTY, IOWA. TIES AS INDICATED.

CORNERS TO BE INDEXED

CORNER SECTION TOWNSHIP RANGE
CENTER 21 84N 1W

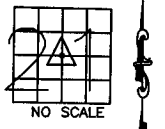

OFFICE FILE NO.
84121m_011304.jpg

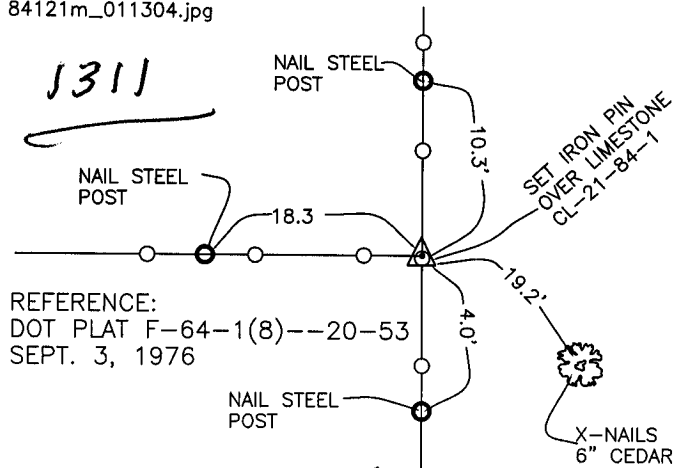

REFERENCE:
DOT PLAT F-64-1(8)--20-53
SEPT. 3, 1976

PREVIOUSLY RECORDED IN BOOK _____, PAGE _____
MONUMENT DESCRIPTION AND HOW ESTABLISHED FOUND
10"x15"x24" LIMESTONE BELOW OLD POST 21" DOWN. SET IRON PIN
ABOVE STONE WITH TOP 2" ABOVE SURFACE. CENTER OF SECTION
21, TOWNSHIP 84 NORTH, RANGE 1 WEST OF THE 5TH PRINCIPAL
MERIDIAN, JONES COUNTY, IOWA. SET REFERENCE POINTS AS
INDICATED.

CORNERS TO BE INDEXED

CORNER SECTION TOWNSHIP RANGE
OFFICE FILE NO.

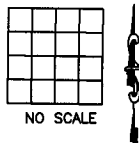

OFFICE FILE NO.

PREVIOUSLY RECORDED IN BOOK _____, PAGE _____
MONUMENT DESCRIPTION AND HOW ESTABLISHED _____

CORNERS TO BE INDEXED

CORNER SECTION TOWNSHIP RANGE
NORTHEAST 21 84N 1W

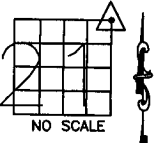

OFFICE FILE NO.
84121e_011304.jpg

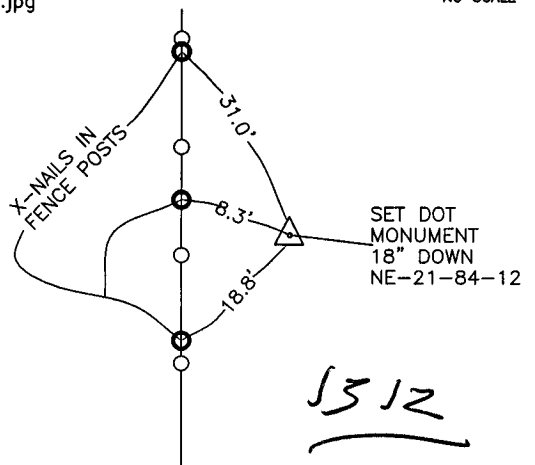

REFERENCE:
DOT PLAT F-64-1(8)--20-53
FEB. 27, 1979

PREVIOUSLY RECORDED IN BOOK _____, PAGE _____
MONUMENT DESCRIPTION AND HOW ESTABLISHED SET
D.O.T. MONUMENT 18" BELOW SURFACE. NORTHEAST CORNER SECTION
21, TOWNSHIP 84 NORTH, RANGE 1 WEST OF THE 5TH PRINCIPAL
MERIDIAN, JONES COUNTY, IOWA. TIES AS INDICATED.

~~I hereby declare that this plat, survey or report was made by me or under my direct personal supervision and that I am a duly registered Land Surveyor under the laws of the State of Iowa.~~

Signed: _____

SEAL

JONES COUNTY
ENGINEER'S OFFICE

19501 HWY. 64,
ANAMOSA, IOWA,
52205 (319)462-3785